



**TOWN OF MEDWAY**  
**COMMONWEALTH OF MASSACHUSETTS**  
**HISTORICAL COMMISSION**

Medway Town Hall  
155 Village Street  
Medway, MA 02053  
Phone (508) 321-4890  
Email:  
historicalcom@townofmedway.org  
www.townofmedway.org

**Minutes**

Wednesday, September 2, 2020, 7:00 p.m.

Zoom

*Commission  
Members*

Jeanne Johnson,  
Chair

Paul Russell, Vice  
Chair

Eugene Liscombe,  
Treasurer,  
Representative to  
Community  
Preservation  
Committee

Cher Hamilton,  
Member

McKenzie Ward,  
Member

**Members in Attendance(virtually):** Jeanne Johnson, Cher Hamilton, Gene Liscombe, Paul Russell

**Members Absent:** McKenzie Ward

**Others Present (virtually):** Barbara Saint Andre, Director of Community and Economic Development, Katherine Mitchell, Recording Secretary

Meeting was called to order by Historical Commission Chair, Jeanne Johnson at 7:04PM.

**I. New Demo Applications and Property Questions - None**

**II. Consider minutes of August 12, 2020**

a. On a motion made by Gene Liscombe, seconded by Cher Hamilton, the Historical Commission voted unanimously by roll call vote to approve minutes of August 12, 2020.

|                |                          |
|----------------|--------------------------|
| Jeanne Johnson | Aye                      |
| Paul Russell   | Abstain (absent meeting) |
| Cher Hamilton  | Aye                      |
| Gene Liscombe  | Aye                      |

**III. Treasurer's report (Gene Liscombe)**

- a. Gene stated there was one item to report from June 30<sup>th</sup>, Historical Commission supplies. \$16 bill for binding of the Evergreen Cemetery Application for nomination to the National Register of Historic Places.
- b. Gene stated there is \$2,684 remaining in the account, the same as reported in August

**IV. CPC Report (Gene Liscombe)** CPC did not have a meeting.

Paul asked about getting funding for new/additional fencing for the dog park at the Garnsey Historical site. Gene asked him to send the cost estimate quote to him to discuss at next CPC meeting. This will require the CPC to call a meeting of their committee.

**V. Updates on ongoing projects**

**a. Evergreen Cemetery update (Paul Russell)** Paul stated he has not heard back from the State Historical Commission on the meeting to approve the application for Evergreen Cemetery to be listed by the National Register of Historic Places. Paul believes they are running behind due to Coronavirus. Jeanne brought Gene the bound application to review. All members agreed it was a lot of work and effort. Paul did an exemplary job compiling all the information gathered over the years, including his work, time spent photographing tombstones, and research, and turning it

over to PAL (Public Archeology Lab) researchers to complete the necessary research and put it together in this bound application.

**b. Boston Post cane.** Paul has the Cane in a cardboard tube safe to give to Esther Fox. Jeanne spoke to Esther – she lives now at Mahan Circle and believes she’s 101 years of age. She was a teacher in Maine, then taught in Bellingham until retirement. Jeanne spoke to Esther’s son Charlie about presenting the cane to his mother as Medway’s oldest resident, and he was pleased; he works full time and is available only on weekends. Esther was interested in the idea. Courtney Riley, director of the Senior Center, said they could have someone there on the weekend once a date is set. Paul stated they’ll want to get Milford News involved. Jeanne will speak to Mary Jane White and reach out to Esther’s son, Charlie, to make arrangements.

**c. Garnsey site (Dog Park).** Paul does not have updates.

**d. High school Students Future Involvement.** Medway schools will have a hybrid model with some students in school and some online. Once things settle down, Paul stated he would contact Melanie Sabtchev in the High School History Department about students being involved with the Medway Historical Commission.

**e. Tim Rice - Digitizing photos.** Cher stated Tim was working on a back to school project with the kids. He continues to work on digitizing.

**58 Oakland Street-** This is not a formal request. The house came before the Historical Commission about 2015-2016. There was no objection to demolition then as the house was vacant, in poor condition, not within a historic district, and not of a unique design or architecture. We did not feel the need to preserve the house at this time and there was no need to vote. Barbara or Stefany emailed this information to Jeanne.

**On a motion made by Paul; seconded by Gene, the Historical Commission voted unanimously by roll call vote to adjourn at 7:19 PM.**

|                       |            |
|-----------------------|------------|
| <b>Jeanne Johnson</b> | <b>Aye</b> |
| <b>Cher Hamilton</b>  | <b>Aye</b> |
| <b>Paul Russell</b>   | <b>Aye</b> |
| <b>Gene Liscombe</b>  | <b>Aye</b> |

**Next meeting is scheduled for Wednesday, October 7, 2020, via Zoom at 7:00 p.m.**

Respectfully submitted,

Katherine Mitchell, Recording Secretary

Aside – Morgan Harris submitted her request to be appointed to the Historical Commission. Her request is on the Agenda for next Tuesday the 8<sup>th</sup>. 7 PM. Selectmen’s Meeting.

Sketches of the Dog Park provided by Paul Russell

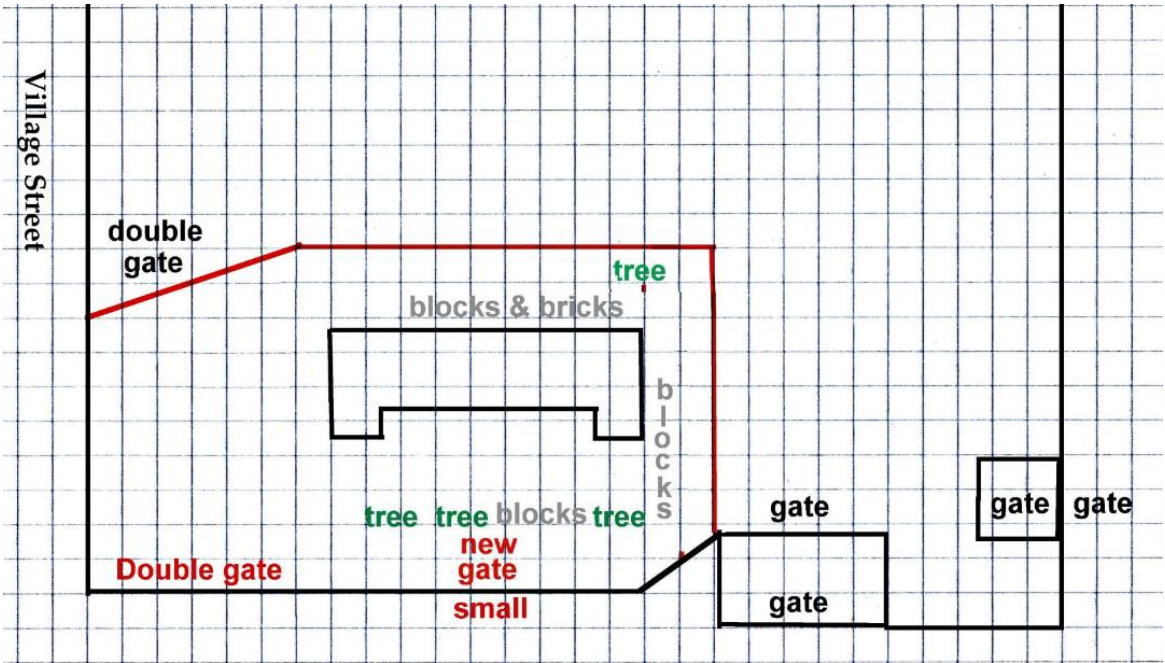
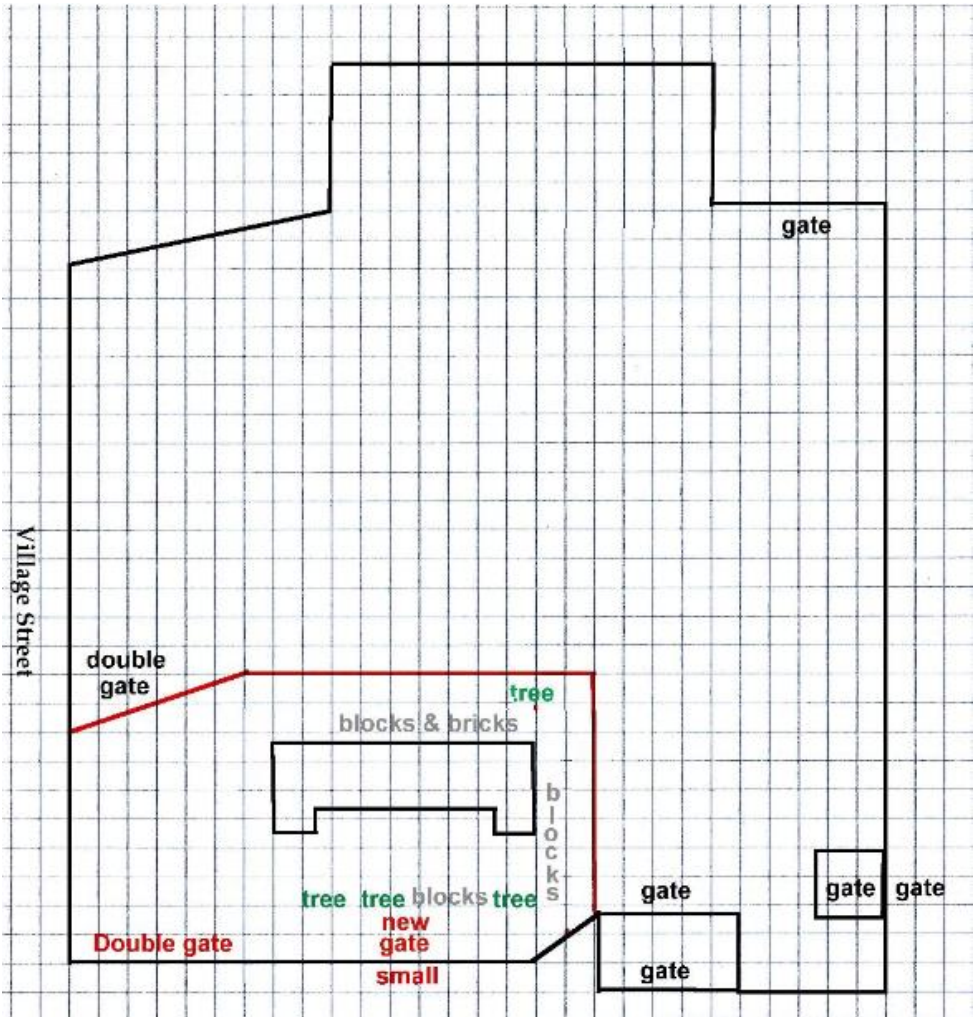

Estimate to be presented to CPC for approval to be purchased

**AnyFence Co.**

1506 Washington Street  
Holliston, MA 01746  
(508) 429-4000  
www.anyfence.com



**Estimate**

**ADDRESS**

Mr. Steve Carew  
Attn: Steve Carew  
45 B Holliston St.  
Ma  
Medway, MA 02038

**ESTIMATE #** 2020-1114

**DATE** 07/13/2020

**SALES REP**

JB-2020-5-40

| DESCRIPTION  | QTY | RATE   | AMOUNT   |
|--|-----|--------|----------|
| DOG PARK ENCLOSURE 298 VILLAGE ST MEDWAY CHAIN LINK                            |     |        |          |
| 6'h chain link materials - black   | 120 | 14.00  | 1,680.00 |
| 6'h x 14'w black chain link DD gate w/ hardware                                | 1   | 850.00 | 850.00   |
| 6'h x 5'w black chain link walk gate w/ hardware                               | 1   | 325.00 | 325.00   |
| Concrete   | 24  | 8.00   | 192.00   |
| Installation chain link (digging, insert, level, concrete, assemble, backfill) | 120 | 10.00  | 1,200.00 |
| Installation gates (hang gates) 1 walk gate, 2 double drive gates              | 5   | 25.00  | 125.00   |

**NOTE:**

Cut into existing fence line at parking lot & install new walk gate.  
Reuse existing double drive gate from street side on new line.  
Install new gate to fit existing opening at street.

NOTE:

**TOTAL**

**\$4,372.00**

Any Fence is currently running at 6-8 weeks from the time we receive a PO