



Town of Medway
DESIGN REVIEW COMMITTEE
155 Village Street
Medway MA 02053
508-533-3291
drc@townofmedway.org

June 18, 2018

Ms. Meghan O'Brien
PO Box 650
Medfield, MA 02052

RE: DRC Sign Design Review
O'Brien & Sons
17 Trotter Drive – Medway, MA

Dear Ms. O'Brien,

Thank you for submitting the proposed signage for O'Brien and Sons new headquarters building at 17 Trotter Drive to the Medway Design Review Committee (DRC) for review. The information was filed with the Town on May 24, 2018.

Pursuant to the Medway Zoning Bylaw, SECTION 7.2 Sign Regulations, this communication serves as the DRC's review letter regarding the proposed free-standing monument sign and wall sign for O'Brien & Sons. Please be advised that this letter does NOT constitute approval of a sign permit. You must still apply for and secure a sign permit from the Medway Building Department prior to sign installation. Do not install the sign before obtaining the required permit.

On Monday, June 4, 2018 the DRC met with you to review the proposed signage for the new O'Brien and Sons facility. You have proposed the following as represented on the sign designs submitted. (**See Attached**).

- Free Standing Monument Sign 66" x 39" (17.8 SF per side x 2 sides = 35.8 SF total). The sign is an aluminum tube frame structure with vinyl graphics. It is a non-illuminated sign. The sign will be located at the main entrance to O'Brien and Sons
- Wall/Façade Sign 144" x 54" for a total of 54 SF. The sign is a fabricated aluminum logo with painted faces mounted on a raceway which will be painted the same color as the building.

The DRC offers the following comments/recommendations regarding the proposed signs for O'Brien and Sons.

Design Review Committee Members

Matthew Buckley, Member & Chair
Rachel Walsh, Member & Vice Chair
Jessica Chabot, Member & Corresponding Secretary

Dan Connolly, Member
Tom Gay, Planning and Economic Development
Board Representative

Seth Kendall, Member
Alex Kevork, Member

- The applicant has stated there is no proposed lighting for the signs. The DRC recommends that if the applicant chooses to add lighting in the future, the lighting be LED down lights as opposed to ground mounted spot lights.

You indicated that you would consider these suggestions and move ahead. You are welcome to return to a future DRC meeting for further conversation and ideas regarding signage for O'Brien & Sons. Please contact the Medway Planning and Economic Development office at 508-533-3291 if you would like to schedule another appointment with the DRC.

The DRC's goal is to enhance the identification value of business signs in Medway. We seek to help Medway businesses and organizations develop their signs as long-term investments, designed for sound readability with appropriate graphics and materials in a manner that suits budgetary constraints and enhances our community's appearance and appeal.

Thank you for your time. We wish O'Brien & Sons much success at its new home in Medway. Congratulations and welcome!

Sincerely,



Matthew J. Buckley
Chairman

cc: Jack Mee, Medway Building Commissioner
Jill Karakeian, Medway Building Department
Rindo Barese, Medway Building Department
Megan Bradley, Sunshine Signs



**O'BRIEN
& SONS**

ELEMENTS FOR A GREAT OUTDOORS

17 Trotter Drive

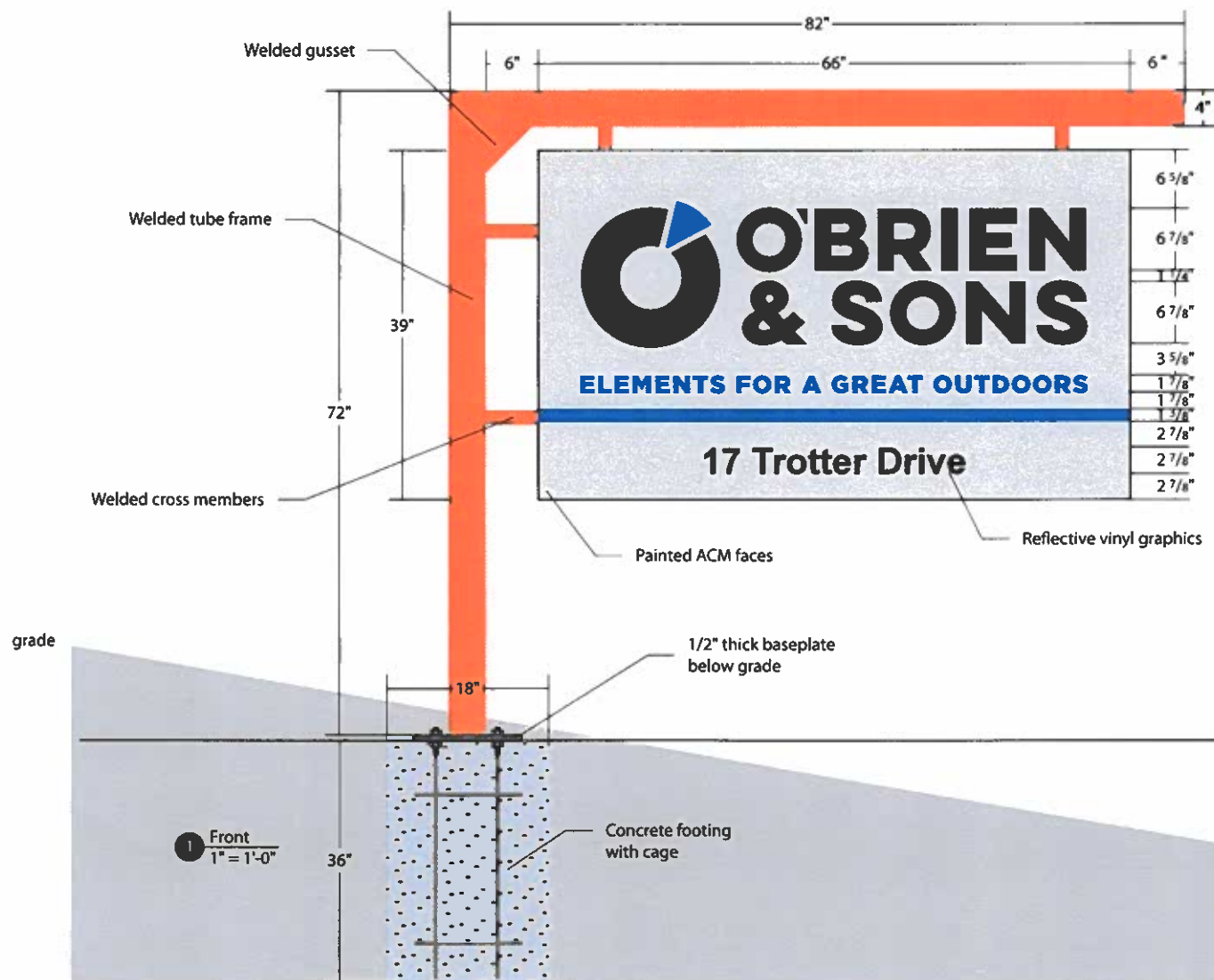

SIGN
TYPE **A**

MAIN ID

Quantity (1)

4"x 4" aluminum tube frame structure with painted ACM faces and reflective vinyl graphics. 1/2" thick baseplate buried below grade with concrete footing reinforcement.

PALETTE

- PAINT:** BM Calypso Orange 2015-30
- VINYL:** : To match BM Polo Blue 2062-10
- VINYL:** To match PMS 641C
- PAINT:** Matthews Brushed Aluminum

CLIENT: RUBICON BUILDERS PROJECT / SIGN TYPE: O'BRIEN & SONS SIGNS DRAWN BY: EL JOB #: 4545-57929 DATE: MAY 9, 2018

SUNSHINE
sign

121 Westboro Road
North Grafton, MA 01536
P 508.839.5588
F 508.839.9929
www.sunshinesign.com

This drawing is given in confidence and may not be used or disseminated in any way without prior written consent from Sunshine Sign Company, Inc. All common law and copyright laws are hereby specifically reserved.

- ☐ Approved for Fabrication
- ☐ Approved as Noted
- ☐ Revise and Resubmit
- ☐ Rejected

Name _____
Signature _____

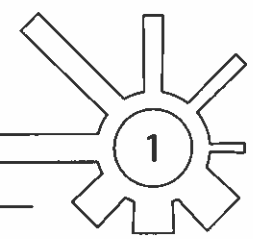

SIGN TYPE: A



1 Front
1" = 1'-0"

SIGN
TYPE B

Fabricated Logo

Quantity (1)

Fabricated aluminum logo with painted faces and returns. Mounted to railings with dimensions TBV.

PALETTE



PAINT: To match BM Polo Blue 2062-10



PAINT: To match PMS 641C

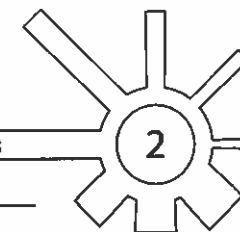

SIGN TYPE: B

SUNSHINE
sign

121 Westboro Road
North Grafton, MA 01536
P 508.839.5588
F 508.839.9929
www.sunshinesign.com

PROJECT / SIGN TYPE: O'BRIEN & SONS SIGNS

This drawing is given in confidence and may not be used or disseminated in any way without prior written consent from Sunshine Sign Company, Inc. All common law and copyright laws are hereby specifically reserved.

DRAWN BY: EL

JOB #: 4545-57929

DATE: MAY 9, 2018

☐ Approved for Fabrication

☐ Revise and Resubmit

☐ Approved as Noted

☐ Rejected

Name

Signature

2

G:\18477 Medway\DWG\8477_LAND.dwg

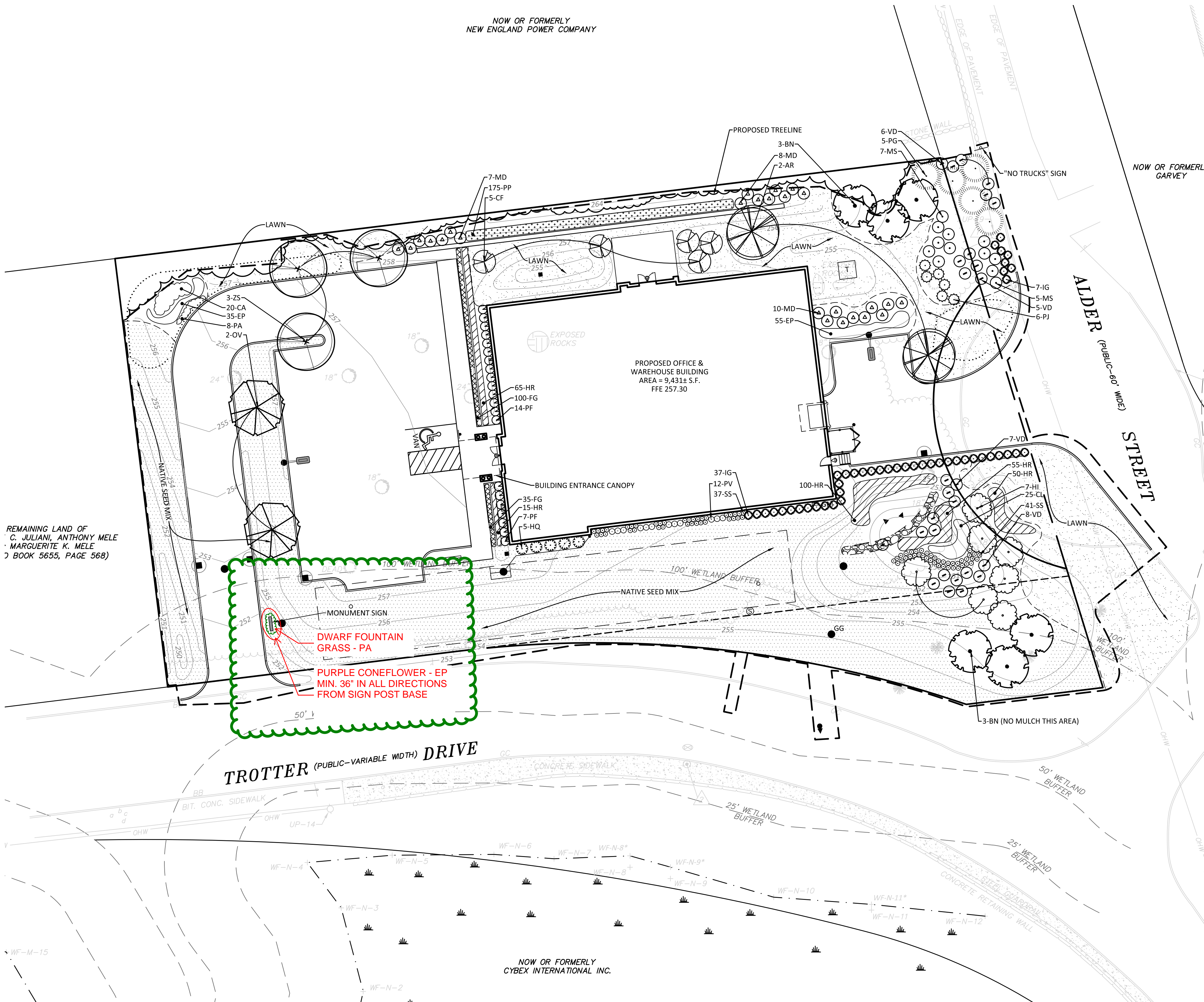

PROPOSED LEGEND

LIMIT OF WORK LINE

SHRUBS, PERENNIALS, GROUNDCOVERS & VINES

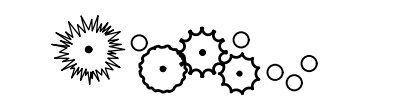

EVERGREEN, SHADE & ORNAMENTAL TREES

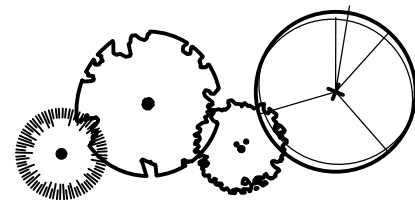

PLANT SCHEDULE

TREES				
QTY	SYM	LATIN NAME	COMMON NAME	SIZE
2	AR	Acer rubrum	Red Maple	3"-3.5" Cal., B&B
6	BN	Betula nigra	River Birch	10'-12' Ht., B&B
5	CF	Cornus florida	Flowering Dogwood	2"-2.5" Cal., B&B
2	OV	Ostrya virginiana	Eastern Hop Hornbeam	2.5"-3" Cal., B&B
5	PG	Picea glauca 'Conica'	Conical White Spruce	3.5'-4' Ht., #10 Pot,
3	ZS	Zelkova serrata 'Village Green'	Village Green Japanese Zelkova	2.5" Cal. B&B

SHRUBS				
7	HI	Hamamelis x intermedia 'Arnold Promise'	Arnold Promise Witch Hazel	24"-30" Ht., #10 Pot
5	HQ	Hydrangea quercifolia 'Flemingea'	Snow Queen Oakleaf Hydrangea	30"-36" Ht., B&B
10	IG	Ilex glabra 'Shamrock'	Shamrock inkberry	24"-30" Ht., B&B
6	PJ	Pieris japonica 'Mountain Fire'	Mountain Fire Andromeda	24"-30" Ht., #3 Pot
21	PF	Potentilla fruticosa	Shrubby Cinquefoil	18"-24" Ht., #3 Pot
26	VD	Viburnum dentatum	Arrowwood Viburnum	36"-60" Ht., #7 Pot

GROUND COVER				
90	EP	Echinacea purpurea	Purple Coneflower	#1 Pot
285	HR	Hemerocallis 'Happy Returns'	Happy Returns Daylily	#1 Pot
25	MD	Microbiota decussata	Russian Cypress	#5 Pot
175	PP	Phlox paniculata 'Bright Eyes'	Bright Eyes Phlox	#1 Pot

ORNAMENTAL GRASSES				
20	CA	Calamagrostis x acutiflora 'Karl Foerster'	Karl Foerster Feather Reed Grass	#2 Pot
25	CL	Chasmanthium latifolium	Northern Sea Oats	#1 Pot
135	FG	Festuca glauca 'Elijah Blue'	Elijah Blue Fescue	#1 Pot
12	MS	Miscanthus Sinensis 'Gracillimus'	Maiden Grass	#3 Pot
12	PV	Panicum virgatum 'Northwind'	Northwind Switchgrass	#3 Pot
8	PA	Pennisetum alopecuroides 'Hamel'	Dwarf Fountain Grass	#2 Pot
78	SS	Schizachyrium scoparium	Little Bluestem	#2 Pot

ABBREVIATIONS:
B&B: BAIL AND BURLAP
CAL: CALIPER
DR: DEER RESISTANT
DT: DROUGHT TOLERANT
N: NATIVE
OC: ON CENTER
ST: SALT TOLERANT

LANDSCAPE NOTES

SPACE PLANTS AT SCALED DISTANCES SHOWN ON DRAWINGS UNLESS OTHERWISE INDICATED.

ANY PROPOSED SUBSTITUTION OF PLANT MATERIAL SHALL ONLY BE MADE AFTER PRIOR APPROVAL OF LANDSCAPE ARCHITECT.

ALL PLANT MATERIAL SHALL CONFORM TO THE MINIMUM GUIDELINES ESTABLISHED BY THE AMERICAN STANDARD FOR NURSERY STOCK PUBLISHED BY THE AMERICAN ASSOCIATION OF NURSERYMEN, INC.

ALL PLANTING BEDS TO BE FILLED WITH SOIL AND CROWNED ABOVE ADJACENT LAWN OR IMPROVED AREAS. ALL PLANTING BEDS TO BE MULCHED WITH AGED HARDWOOD BARK MULCH TO A DEPTH OF THREE (3) INCHES.

PROVIDE FIVE (5) FOOT DIAMETER MULCH CIRCLE AROUND ALL INDIVIDUAL TREE PLANTINGS AND CONTINUOUS MULCH BED AROUND SHRUB PLANTINGS.

PLANT MATERIALS SHALL BEAR SAME RELATIONSHIP TO FINISH GRADE AS THEY BORE TO GRADE IN THE NURSERY.

ALL PLANT MATERIALS AND LAWN AREAS TO BE MAINTAINED BY LANDSCAPE CONTRACTOR UNTIL FINAL WRITTEN ACCEPTANCE PROVIDED TO CONTRACTOR BY OWNER OR HIS REPRESENTATIVE.

ALL PLANT MATERIALS SHALL BE GUARANTEED FOR ONE YEAR FOLLOWING DATE OF FINAL WRITTEN ACCEPTANCE FROM THE OWNER OR HIS REPRESENTATIVE.

ALL PLANT MATERIALS ARE INTENDED TO BE DROUGHT TOLERANT ONCE ESTABLISHED.

REUSE EXISTING TOPSOIL ENCOUNTERED ON-SITE AND AMEND TO PARAMETERS LISTED BELOW. IF ADDITIONAL TOPSOIL IS NEEDED PROVIDE FERTILE, FRIABLE, NATURAL TOPSOIL OF LOAMY CHARACTER (FOR PLANTING MIX), WITHOUT ADMIXTURE OF SUBSOIL MATERIAL, OBTAINED FROM A WELL-DRAINED SITE, REASONABLY FREE OF CLAY, LUMPS, COARSE SANDS, STONES, PLANTS, ROOTS, STICKS AND OTHER FOREIGN MATERIALS, WITH ACIDITY RANGE OF BETWEEN PH 6.0 AND 6.8. TOPSOIL SHALL NOT BE DELIVERED OR WORKED IN A MUDDY OR FROZEN CONDITION.

PLANTING MIX: MIX THE SPECIFIED MATERIALS IN THE FOLLOWING PROPORTIONS:
3 PARTS TOPSOIL, 1 PART PEAT MOSS, 1 PART SAND, WITH 5 POUNDS OF SUPERPHOSPHATE/ CUBIC YARD OF MIXTURE (ONLY IF PLANTS ARE INSTALLED IN SPRING). ALL AMENDMENTS SHALL BE THOROUGHLY INCORPORATED INTO MIXTURE TO ASSURE UNIFORM DISTRIBUTION.

PLANTING MIX SHALL BE SPREAD TO A MINIMUM DEPTH OF SIX (6) INCHES AFTER SETTLING ON ALL DISTURBED AREAS, TURFGRASS LAWN AREAS AND PLANTING BED SUBGRADE AREAS UPON COMPLETION OF FINAL GRADING. SEEDING OPERATION OR SPREADING OF TURFGRASS SOD TO BE COMPLETED IMMEDIATELY FOLLOWING THE APPLICATION OF THE PLANTING MIX OVER THE SUBGRADE. SCARIFY SUBGRADE TO A DEPTH OF 2" BEFORE PLACING TOPSOIL.

SEED OR PROVIDE SOD FOR ALL TURFGRASS LAWN AREAS WITH A DROUGHT TOLERANT TURFGRASS SEED MIX (80% TALL FESCUE, 10% PERENNIAL RYEGRASS, 10% KENTUCKY BLUEGRASS).

CONTRACTOR SHALL VERIFY QUANTITIES SHOWN ON PLANT LIST. QUANTITIES SHOWN ON PLANS SHALL GOVERN.

NATIVE SEED MIX SHALL BE "NEW ENGLAND NATIVE WARM SEASON GRASS MIX" AS SUPPLIED FROM NEW ENGLAND WETLAND PLANTS, WWW.NEWP.COM. SPECIES INCLUDED: LITTLE BLUESTEM, (SCHIZACHYRIUM SCOPARIUM), BIG BLUESTEM, (ANDROPOGON GERARDII), VIRGINIA WILD RYE, (ELYMUS VIRGINICUS), INDIAN GRASS, (SORGHASTRUM NUTANS), CREEPING RED FESCUE, (FESTUCA RUBRA), SWITCH GRASS, (PANICUM VIRGATUM).

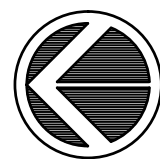

SCALE: 1" = 20'

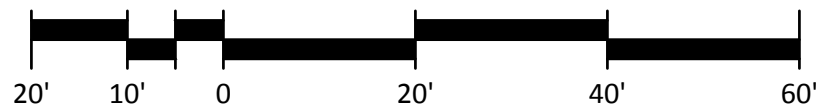

O'BRIEN & SONS CORPORATE OFFICE

17 TROTTER DRIVE,
MEDWAY, MA 02053

O'BRIEN & SONS

93 WEST STREET
MEDFIELD, MA 02052

G|R|L|A

Gorman Richardson Lewis Architects
239 South Street Hopkinton, MA 01748
T - 508.544.2600 F - 508.435.0072
www.griarchitects.com



MERIDIAN ASSOCIATES

500 CUMMINGS CENTER, #550, BEVERLY, MA 01915 1978.299.0447
69 MILL STREET, #102, WESTBOROUGH, MA 01581 508.871.7039

No. Description Date

© COPYRIGHT 2017

ALL DRAWN OR WRITTEN INFORMATION OR GRAPHICS APPEARING HEREIN SHALL REMAIN THE PROPERTY OF GORMAN RICHARDSON LEWIS ARCHITECTS, INC. AND AS SUCH IS NOT TO BE DUPLICATED, REPRODUCED, COPIED, OR OTHERWISE USED WITHOUT THE EXPRESS WRITTEN CONSENT OF GORMAN RICHARDSON LEWIS ARCHITECTS, INC.

ALL DRAWN OR WRITTEN INFORMATION OR GRAPHICS HEREIN IS NOT GUARANTEED AGAINST DEFECTS THAT ARE NOT LIMITED TO, BUT NOT LIMITED TO, ERRORS AND OMISSIONS, DESIGN CALCULATIONS AND DIMENSIONS, DATA TRANSMISSION, OR DATA TRANSLATION.

Date: NOVEMBER 17, 2017

Proj. No.: 8477

Scale: 1" = 20'

Drawn By: JBT

Checked By: MEB

Landscape Plan

C4.01

2016068.01 - O'BRIEN & SONS O'BRIEN & SONS CORPORATE OFFICE PERMIT SET - NOVEMBER 17, 2017