

Monday, October 30, 2017
Medway Planning and Economic Development Board
155 Village Street
Medway, MA 02053

Members	Andy Rodenhiser	Bob Tucker	Tom Gay	Matt Hayes	Rich Di Iulio
Attendance	X	X	X	X	X

ALSO PRESENT:

- Susy Affleck-Childs, Planning and Economic Development Coordinator

There were no Citizen Comments.

143 Village Street Special Permit – Public Hearing Continuation

The Board is in receipt of the following documents: **(See Attached)**

- Public Hearing Continuation Notice dated 10/25/17
- Series of emails among Susy Affleck-Childs, Sean Reardon and Dale MacKinnon
- Revised Grading, Utilities and Erosion Control Plan and details dated 10/25/17 by Guerriere and Halnon
- Revised curb radii drawing by Guerriere and Halnon dated 10/26/17
- Curb radii options drawing by Tetra Tech provided 10/26/17
- Revised draft decision dated 10/27/17
- Revised site plan dated 10/27/17
- Email from Sean Reardon dated 10/30/2017.

There was a meeting with the applicant, Susy, DPS Director Dave D'Amico and DPS Highway Superintendent Jack Tucker on Thursday, 10/26/17. Engineering consultant Sean Reardon joined by conference call. The discussion focused on the curb at the southwest corner of the intersection of Sanford and Village Streets and truck traffic and the location of the sidewalk. The Board wants to get the sidewalk off of private property and onto the Town right-of-way. The group reviewed the revised grading, utilities and erosion control plan and details. A corner radius of 50 ft. was discussed with a sidewalk of 5 ½ feet at the back edge of existing corner. There was discussion that the radius should not be smaller than 38.6 ft.

The Board discussed an email communication from Sean Reardon on 10/26/17 in which he recommended a 35 ft. corner radius in order to slow down traffic turning the corner from eastbound Village to southbound Sanford Street.

The Board was made aware that Sergeant Watson spoke with Susy Affleck-Childs and with Sean Reardon. He is not completely comfortable with the 35 ft. curb radius. Sean recommended holding off on making a decision but include language in a condition of the decision that this will be decided when construction starts.

The plan will show a 35' radius with the understanding that it may be modified in the field upon consultation with Safety Officer Sergeant Jeff Watson.

The applicant was reminded to check the layout for the ramps and crosswalks which must line up when going across Sanford Street. The tactile strips also need to line up for blind residents.

The plan for lighting was shown. The site plan has been revised and it meets the Town's standards.

The applicant is aware of the risk of starting the work within the 20 day appeal period. A pre-construction meeting will be held immediately for this project.

There was a clarification made that the fencing will be on the western boundary only and not Southern. This should be reflected on the plan.

There will be no snow storage on site. Snow will need to be removed from the site.

The Board reviewed the draft decision.

Findings:

On a motion made by Bob Tucker and seconded by Rich Di Iulio, the Board voted unanimously to approve the Findings.

Waivers/conditions:

On a motion made by Bob Tucker and seconded by Rich Di Iulio, the Board voted unanimously to approve the Waivers for 143 Village Street.

Decision:

On a motion made by Bob Tucker and seconded by Rich Di Iulio, the Board voted unanimously to approve the Decision for 143 Village Street with waivers and conditions.

Close Hearing.

On a motion made by Rich Di Iulio and seconded by Matt Hayes, the Board voted unanimously to close the hearing for 143 Village Street.

The decision will be filed with the Town Clerk on October 31, 2017.

Construction Estimates:

Country Cottage: (See Attached)

On a motion made by Bob Tucker and seconded by Rich Di Iulio, the Board voted unanimously to accept the construction estimate for Country Cottage in the amount of \$9,890.00.

143 Village Street: (See Attached)

On a motion made by Bob Tucker and seconded by Rich Di Iulio, the Board voted unanimously to accept the construction estimate for 143 Village Street in the amount of \$8,756.00.

PEDB Meeting Minutes

October 17, 2017:

On a motion made by Rich Di Iulio, and seconded by Matt Hayes, the Board voted unanimously to accept the minutes from October 17, 2017 with noted revisions.

Adjourn:

On a motion made by Rich Di Iulio and seconded by Matt Hayes, the Board voted unanimously to adjourn the meeting.

The meeting was adjourned at 8:06 pm.

Respectfully Submitted,

A handwritten signature in blue ink, appearing to read "Amy Sutherland".

Amy Sutherland
Recording Secretary

Reviewed and edited by,

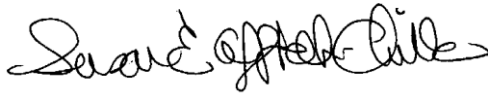
A handwritten signature in black ink, appearing to read "Susan E. Affleck-Childs".

Susan E. Affleck-Childs
Planning and Economic Development Coordinator

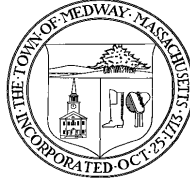

October 30, 2017
Medway Planning & Economic Development Board
Meeting

143 Village Street – Public Hearing
Continuation

- Public Hearing Continuation Notice filed 10/25/17
- Series of emails 10/25 – 10/26 among Susy, Dale MacKinnon of Guerriere and Halnon and Sean Reardon
- Revised Grading, Utility and Erosion Control Plan and Details dated 10/25/17 by Guerriere & Halnon
- Revised radii drawing by Guerriere & Halnon
- Curb radii options drawing from Tetra Tech
- Revised DRAFT decision dated 10/27/17

Work continues to refine a proposal for the turning radius at the southwest corner of Sanford and Village Streets. See the collection of emails. A meeting was held yesterday morning with Dale MacKinnon of Guerriere and Halnon along with Dave D'Amico and Highway Superintendent Jack Tucker to review a drawing (see attached) prepared by Guerriere & Halnon that showed the Sanford street sidewalk moved off of private property. Sean Reardon called in for that meeting. G & H then prepared a revised drawing (see attached) which was reviewed by Tetra Tech. See Tetra Tech's email comment and drawing showing various radii options. G & H is preparing a further revised drawing to depict the 35' radius as recommended by Tetra Tech. I will forward that to you upon receipt.

I am meeting early Friday afternoon with Sergeant Jeff Watson to discuss the changes and to see if he is OK with a 35' corner radius.



TOWN OF MEDWAY
Planning & Economic Development Board
155 Village Street
Medway, Massachusetts 02053

RECEIVED

OCT 25 2017

TOWN CLERK

Andy Rodenhiser, Chairman
Robert K. Tucker, Vice-Chairman
Thomas A. Gay, Clerk
Matthew Hayes, P.E.
Richard Di Iulio

MEMORANDUM

October 25, 2017

TO: Maryjane White, Town Clerk
Town of Medway Departments, Boards and Committees

FROM: Susy Affleck-Childs, Planning & Economic Development Coordinator

RE: **Public Hearing Continuation: 143 Village Street Special Permits**
Continuation Date: Monday, October 30, 2017 at 7:00 p.m.
Location: Medway Town Hall – Sanford Hall, 155 Village Street

At its meeting on October 24, 2017, the Planning and Economic Development Board voted to continue the public hearing on the application of N.E. Premier Properties, LLC of Franklin, MA for approval of a Multifamily Housing Special Permit and associated plan entitled *Multi Family Housing Special Permit 143 Village Street* dated September 6, 2017, last revised October 10, 2017, prepared by Guerriere and Halnon of Franklin, MA and a groundwater protection district special permit. **The continued public hearing will take place on Monday, October 30, 2017 at 7:00 p.m. in Sanford Hall at Medway Town Hall, 155 Village Street.**

The applicant proposes to develop a 3 unit residential condominium in the existing building at 143 Village Street. The parcel is located at the southwest corner of Village and Sanford Streets in the Village Commercial zoning district. The 5,868 sq. ft. site (*Medway Assessors Map 60, Parcel 92*) is currently owned by the Estate of Virginia Heavey. This is a pre-existing, non-conforming parcel which includes a building constructed in 1910. The building is also pre-existing, non-conforming in terms of zoning setbacks on the site. The property is located within the Town's multifamily housing overlay district and the groundwater protection district.

The proposed redevelopment of the existing building will include three dwelling units. Six parking spaces will be provided. Vehicular access will be from Sanford Street. Stormwater management facilities will be installed on site as will landscaping, walkways, and retaining walls.

The application, site plan, and other documents are on file with the Medway Town Clerk and at the office of the Planning and Economic Development Board at Medway Town Hall, 155 Village Street and may be reviewed during regular business hours. The application, site plan, and other documents are also posted at the Planning and Economic Development Board's web page at:

<https://www.townofmedway.org/planning-economic-development-board/pages/143-village-street-multifamily-housing-groundwater>

The Board will conclude its review of this project at the next meeting, vote its decision and close the hearing. This is your last opportunity to provide any review comments if you wish to do so.

Susan Affleck-Childs

From: Reardon, Sean <sean.reardon@tetrattech.com>
Sent: Thursday, October 26, 2017 11:46 AM
To: Susan Affleck-Childs
Subject: RE: 143 Village Street - next steps
Attachments: 143 Village Curb Radii.jpg

Hi Susy.

Steve and I took a look at the plan and don't share Dale's concern regarding the size of the curb radius. Curb radii at intersections are frequently smaller than 38.6'. Trucks turning onto Sanford from Village have more than enough travel lane to make the turn safely since they are able to track a wider line closer to the roadway centerlines.

What G&H shows will work, however a more typical layout would have a single curve connecting the curb lines of Sanford and Village. The attached figure shows 3 radii options worth considering. The 42' radii will not work since there isn't enough room to keep sidewalk in the public ROW.

Red=35'
Yellow=38'
Magenta=42'

A 35' radii that is tangent to curb of Sanford and Village is our preferred layout. It shortens the crossing distance, establishes a clean gutter line geometry and doesn't extend too far beyond the site. I realize this will extend the scope of work and defer to DPS on final decision on best solution.

It would be great to see some spot grades at the corners of the sidewalk transitions to confirm accessibility.

Sean

Sean P. Reardon, P.E. | Vice President
Direct: 508.786.2230 | Main: 508.786.2200 | Fax: 508.786.2201
sean.reardon@tetrattech.com

Tetra Tech, Inc. | Water, Environment and Infrastructure
Marlborough Technology Park | 100 Nickerson Road | Marlborough, MA 01752 www.tetrattech.com

PLEASE NOTE: This message, including any attachments, may include privileged, confidential and/or inside information. Any distribution or use of this communication by anyone other than the intended recipient is strictly prohibited and may be unlawful. If you are not the intended recipient, please notify the sender by replying to this message and then delete it from your system.

From: Susan Affleck-Childs [mailto:sachilds@townofmedway.org]
Sent: Thursday, October 26, 2017 10:43 AM
To: Reardon, Sean <sean.reardon@tetrattech.com>
Subject: FW: 143 Village Street - next steps

Hi Sean,

See note below and attached drawing . . .

Thoughts.

Susy

Susan E. Affleck-Childs
Planning and Economic Development Coordinator

Town of Medway
155 Village Street
Medway, MA 02053
508-533-3291
sachilds@townofmedway.org

Town of Medway – *A Massachusetts Green Community*

Please remember when writing or responding, the Massachusetts Secretary of State has determined that e-mail is a public record.

The information in this e-mail, including attachments, may contain privileged and confidential information intended only for the person(s) identified above. If you are not the intended recipient, you are hereby notified that any dissemination, copying or disclosure of this communication is strictly prohibited. Please discard this e-mail and any attachments and notify the sender immediately.

From: Dale MacKinnon [<mailto:DMackinnon@gandhengineering.com>]
Sent: Thursday, October 26, 2017 10:42 AM
To: Susan Affleck-Childs; NEPREPROP@GMAIL.COM
Cc: Michael Hassett; Donald Neilson (drn5430@hotmail.com); Don Nielsen
Subject: RE: 143 Village Street - next steps

SUSY

PLEASE NOTE THE 3 RADII SHOWN ON THE ATTACHED PLAN.

THE 50 FOOT RADIUS WOULD BE INSIDE THE EXISTING SIDEWALK.

THE PROPOSED LAYOUT WE HAVE SHOWN IN THIS PLAN USING THE PROPERTY LINE AS THE BACK OF THE SIDEWALK PROVIDES A 38.6 FOOT RADIUS.

A PORTION OF THE EXISTING RADIUS IS ABOUT 25 FEET FURTHER ON VILLAGE STREET.

The DPS and Tetra Tech believe the intersection radius for this corner must be maintained as necessary for truck traffic.

IT IS MY PROFESSIONAL OPINION THE RADIUS at this intersection SHOULD NOT BE REDUCED BELOW THE PROPOSED 38.6 FOOT RADIUS.

I SUGGEST THAT YOU SEND THIS EMAIL TO SEAN, TO SEE if he concurs.

IF THERE IS ANYTHING FURTHER I CAN DO TODAY TO HELP ADDRESS THE LAYOUT, PLEASE CONTACT ME.

508-988-5111

DALE

From: Dale MacKinnon
Sent: Wednesday, October 25, 2017 4:12 PM
To: 'Susan Affleck-Childs' <sachilds@townofmedway.org>
Subject: RE: 143 Village Street - next steps

AS REQUESTED.
SEE YOU AT 8 AM

From: Susan Affleck-Childs [<mailto:sachilds@townofmedway.org>]
Sent: Wednesday, October 25, 2017 3:57 PM
To: Dale MacKinnon <DMackinnon@gandhengineering.com>
Subject: RE: 143 Village Street - next steps

Hi Dale,

Just got off the phone with Dave D'Amico, Director of the Medway Department of Public Services (DPS). He is amenable to meeting at 8 am on Thursday morning.

The DPS office is located in the very back wing of the Medway Middle School at 45 Holliston Street. Do not go in thru the main school entrance. The DPS entrance is on the back/southern end of the building off of the parking lot. Enter through Door #9.

Do you have a drawing you can send me or do you want to wait until Thursday morning?

I am going to contact PB Chairman Andy Rodenhiser to see if he could attend.

Susy

Susan E. Affleck-Childs
Planning and Economic Development Coordinator

Town of Medway
155 Village Street
Medway, MA 02053
508-533-3291
sachilds@townofmedway.org

Town of Medway – *A Massachusetts Green Community*

Please remember when writing or responding, the Massachusetts Secretary of State has determined that e-mail is a public record.

The information in this e-mail, including attachments, may contain privileged and confidential information intended only for the person(s) identified above. If you are not the intended recipient, you are hereby notified that any dissemination, copying or disclosure of this communication is strictly prohibited. Please discard this e-mail and any attachments and notify the sender immediately.

From: Dale MacKinnon [<mailto:DMackinnon@gandhengineering.com>]
Sent: Wednesday, October 25, 2017 3:52 PM
To: Susan Affleck-Childs
Subject: RE: 143 Village Street - next steps

Susy
Any luck for meeting early tomorrow?
Dale

From: Susan Affleck-Childs [<mailto:sachilds@townofmedway.org>]
Sent: Wednesday, October 25, 2017 2:14 PM
To: Dale MacKinnon <DMackinnon@gandhengineering.com>
Subject: 143 Village Street - next steps
Importance: High

Hi Dale,

I would like to schedule a meeting with Barry Smith and/or Dave D'Amico of our Department of Public Services to discuss squaring off the corner of Village and Sanford Street and the various sidewalk issues identified last night.

Could you be available early Friday morning?

Susy

Susan E. Affleck-Childs
Planning and Economic Development Coordinator

Town of Medway
155 Village Street
Medway, MA 02053
508-533-3291
sachilds@townofmedway.org

Town of Medway – *A Massachusetts Green Community*

Please remember when writing or responding, the Massachusetts Secretary of State has determined that e-mail is a public record.

The information in this e-mail, including attachments, may contain privileged and confidential information intended only for the person(s) identified above. If you are not the intended recipient, you are hereby notified that any dissemination, copying or disclosure of this communication is strictly prohibited. Please discard this e-mail and any attachments and notify the sender immediately.

CULTEC RECHARGER® 280HD SPECIFICATIONS

- GENERAL
- CULTEC RECHARGER 280HD CHAMBERS ARE DESIGNED FOR UNDERGROUND STORMWATER MANAGEMENT. THE CHAMBERS MAY BE USED FOR RETENTION, RECHARGING, DETENTION OR CONTROLLING THE FLOW OF ON-SITE STORMWATER RUNOFF.
- CHAMBER PARAMETERS
- THE CHAMBERS WILL BE MANUFACTURED BY CULTEC, INC. OF BROOKFIELD, CT. (203-775-4416 OR 1-800-428-5832)
 - THE CHAMBER WILL BE VACUUM THERMOFORMED OF BLACK POLYETHYLENE.
 - THE CHAMBER WILL BE ARCHED IN SHAPE.
 - THE CHAMBER WILL BE OPEN-BOTTOMED.
 - THE CHAMBER WILL BE JOINED USING AN INTERLOCKING OVERLAPPING RIB METHOD. CONNECTIONS MUST BE FULLY SHOULDERED OVERLAPPING RIBS, HAVING NO SEPARATE COUPLINGS OR SEPARATE END WALLS.
 - THE NOMINAL CHAMBER DIMENSIONS OF THE CULTEC RECHARGER 280HD SHALL BE 26.5 INCHES (673 mm) TALL, 47 INCHES (1194 mm) WIDE AND 8 FEET (2.44 m) LONG. THE INSTALLED LENGTH OF A JOINED RECHARGER 280HD SHALL BE 7 FEET (2.13 m).
 - MAXIMUM INLET OPENING ON THE CHAMBER END WALL IS 18 INCHES (450 mm).
 - THE CHAMBER WILL HAVE TWO SIDE PORTALS TO ACCEPT CULTEC HVLV® FC-24 FEED CONNECTORS TO CREATE AN INTERNAL MANIFOLD. NOMINAL INSIDE DIMENSIONS OF THE SIDE PORTAL SHALL HAVE A WIDTH OF 11.25" (286 mm) AND HEIGHT OF 11.25" (282 mm). THE SIDE PORTAL CAN ACCEPT A MAXIMUM OUTER DIAMETER (O.D.) PIPE SIZE OF 12.25 INCHES (311 mm).
 - THE NOMINAL CHAMBER DIMENSIONS OF THE CULTEC HVLV® FC-24 FEED CONNECTOR SHALL BE 12 INCHES (305 mm) TALL, 18 INCHES (406 mm) WIDE AND 24.2 INCHES (614 mm) LONG.
 - THE NOMINAL STORAGE VOLUME OF THE RECHARGER 280HD CHAMBER WILL BE 6.079 FTS / FT (0.565 m³ / m) - WITHOUT STONE. THE NOMINAL STORAGE VOLUME OF A JOINED RECHARGER 280HD SHALL BE 42,553 FTS / UNIT (1,205 m³ / UNIT) - WITHOUT STONE.
 - THE NOMINAL STORAGE VOLUME OF THE HVLV FC-24 FEED CONNECTOR WILL BE 0.913 FTS / FT (0.085 m³ / m) - WITHOUT STONE.
 - THE RECHARGER 280HD CHAMBER WILL HAVE EIGHTY-TWO DISCHARGE HOLES BORED INTO THE SIDEWALLS OF THE UNITS CORE TO PROMOTE LATERAL CONVEYANCE OF WATER.
 - THE RECHARGER 280HD CHAMBER SHALL HAVE 16 CORRUGATIONS.
 - THE ENDWALL OF THE CHAMBER, WHEN PRESENT, WILL BE AN INTEGRAL PART OF THE CONTINUOUSLY FORMED UNIT. SEPARATE END PLATES CANNOT BE USED WITH THIS UNIT.
 - THE RECHARGER 280HD STAND ALONE UNIT MUST BE FORMED AS A WHOLE CHAMBER HAVING TWO FULLY FORMED INTEGRAL END WALLS AND HAVING NO SEPARATE END PLATES OR SEPARATE END WALLS.
 - THE RECHARGER 280HD STARTER UNIT MUST BE FORMED AS A WHOLE CHAMBER HAVING ONE FULLY FORMED INTEGRAL END WALL AND ONE PARTIALLY FORMED INTEGRAL END WALL WITH A LOWER TRANSFER OPENING OF 9 INCHES (229 mm) HIGH X 36 INCHES (889 mm) WIDE.
 - THE RECHARGER 280HD INTERMEDIATE UNIT MUST BE FORMED AS A WHOLE CHAMBER HAVING ONE FULLY OPEN ENDWALL AND ONE PARTIALLY FORMED INTEGRAL END WALL WITH A LOWER TRANSFER OPENING OF 9 INCHES (229 mm) HIGH X 36 INCHES (889 mm) WIDE.
 - THE RECHARGER 280HD END UNIT MUST BE FORMED AS A WHOLE CHAMBER HAVING ONE FULLY FORMED INTEGRAL END WALL AND ONE FULLY OPEN END WALL AND HAVING NO SEPARATE END PLATES OR END WALLS.
 - THE HVLV FC-24 FEED CONNECTOR MUST BE FORMED AS A WHOLE CHAMBER HAVING TWO OPEN END WALLS AND HAVING NO SEPARATE END PLATES OR SEPARATE END WALLS. THE UNIT WILL FIT INTO THE SIDE PORTALS OF THE RECHARGER 280HD AND ACT AS CROSS FEED CONNECTIONS.
 - CHAMBERS MUST HAVE HORIZONTAL STIFFENING FLEX REDUCTION STEPS BETWEEN THE RIBS.
 - HEAVY DUTY UNITS ARE DESIGNATED BY A COLORED STRIPE FORMED INTO THE PART ALONG THE LENGTH OF THE CHAMBER.
 - THE CHAMBER WILL HAVE A RAISED INTEGRAL CAP LOCATED ON TOP OF THE ARCH IN THE CENTER OF EACH UNIT TO BE USED AS AN OPTIONAL INSPECTION PORT OR CLEAN-OUT.
 - THE UNITS MAY BE TRIMMED TO CUSTOM LENGTHS BY CUTTING BACK TO ANY CORRUGATION.
 - THE CHAMBER SHALL BE MANUFACTURED IN AN IN AN ISO 9001:2008 CERTIFIED FACILITY
 - THE CHAMBER WILL BE DESIGNED TO WITHSTAND TRAFFIC LOADS WHEN INSTALLED ACCORDING TO CULTECS INSTALLATION INSTRUCTIONS.
 - MAXIMUM ALLOWED COVER OVER TOP OF UNIT SHALL BE 12 FEET (3.65 m).

CULTEC HVLV® FC-24 FEED CONNECTOR PRODUCT SPECIFICATIONS

- GENERAL
- CULTEC HVLV FC-24 FEED CONNECTORS ARE DESIGNED TO CREATE AN INTERNAL MANIFOLD FOR CULTEC RECHARGER 280HD STORMWATER CHAMBERS.
- CHAMBER PARAMETERS
- THE CHAMBERS WILL BE MANUFACTURED BY CULTEC, INC. OF BROOKFIELD, CT. (203-775-4416 OR 1-800-428-5832)
 - THE CHAMBER WILL BE VACUUM THERMOFORMED OF BLACK HIGH MOLECULAR WEIGHT HIGH DENSITY POLYETHYLENE (HDPE).
 - THE CHAMBER WILL BE ARCHED IN SHAPE.
 - THE CHAMBER WILL BE OPEN-BOTTOMED.
 - THE NOMINAL CHAMBER DIMENSIONS OF THE CULTEC HVLV FC-24 FEED CONNECTOR SHALL BE 12 INCHES (305 mm) TALL, 18 INCHES (406 mm) WIDE AND 24.2 INCHES (614 mm) LONG.
 - THE NOMINAL STORAGE VOLUME OF THE HVLV FC-24 FEED CONNECTOR WILL BE 0.913 FTS / FT (0.085 m³ / m) - WITHOUT STONE.
 - THE HVLV FC-24 FEED CONNECTOR CHAMBER SHALL HAVE 2 CORRUGATIONS.
 - THE HVLV FC-24 FEED CONNECTOR MUST BE FORMED AS A WHOLE CHAMBER HAVING TWO OPEN END WALLS AND HAVING NO SEPARATE END PLATES OR SEPARATE END WALLS. THE UNIT WILL FIT INTO THE SIDE PORTALS OF THE CULTEC RECHARGER STORMWATER CHAMBER AND ACT AS CROSS FEED CONNECTIONS CREATING AN INTERNAL MANIFOLD.
 - THE CHAMBER WILL BE DESIGNED TO WITHSTAND TRAFFIC LOADS WHEN INSTALLED ACCORDING TO CULTECS RECOMMENDED INSTALLATION INSTRUCTIONS.
 - THE CHAMBER SHALL BE MANUFACTURED IN AN ISO 9001:2008 CERTIFIED FACILITY.

CULTEC NO. 20L™ POLYETHYLENE LINER

- GENERAL
- CULTEC NO.™ 20L POLYETHYLENE LINER IS DESIGNED AS AN IMPERVIOUS UNDERLAYMENT TO PREVENT SCOURING OF THE STONE BASE CAUSED BY WATER MOVEMENT WITHIN THE CULTEC SYSTEM. CULTEC NO. 20L POLYETHYLENE LINER IS TO BE PLACED BENEATH HVLV FC-24 FEED CONNECTORS WHEN UTILIZING INTERNAL MANIFOLD AND BENEATH ALL INLET PIPES.
- LINER PARAMETERS
- THE LINER WILL BE PROVIDED BY CULTEC, INC. OF BROOKFIELD, CT. (203-775-4416 OR 1-800-428-5832)
 - THE LINER WILL BE BLACK IN APPEARANCE.
 - THE LINER WILL HAVE A NOMINAL THICKNESS OF 20 MIL (0.51 mm).
 - THE LINER WILL HAVE A WEIGHT OF 93 LBS/MSF (453 g/m²).
 - THE LINER WILL HAVE A TENSILE STRENGTH @ BREAK 1" (2.54 cm) OF 75 LBS (334 n) PER ASTM D6693 TESTING METHOD.
 - THE LINER WILL HAVE AN ELONGATION AT BREAK OF 800% PER ASTM D6693 TESTING METHOD.
 - THE LINER WILL HAVE A TEAR RESISTANCE OF 11 LBF (49 n) PER ASTM D1004 TESTING METHOD.
 - THE LINER WILL HAVE A HYDROSTATIC RESISTANCE OF 100 PSI (689 kpa) PER ASTM D781 TESTING METHOD
 - THE LINER WILL HAVE A PUNCTURE RESISTANCE OF 30 LBF (133 n) PER ASTM D4833 TESTING METHOD.
 - THE LINER WILL HAVE A VOLATILE LOSS OF <1% PER ASTM D1203 TESTING METHOD.
 - THE LINER WILL HAVE A DIMENSIONAL STABILITY OF <2% PER ASTM D1204 TESTING METHOD.
 - THE LINER WILL HAVE A MAXIMUM USE TEMPERATURE OF 180° F (82° C).
 - THE LINER WILL HAVE A MINIMUM USE TEMPERATURE OF -70° F (-57° C).
 - THE LINER WILL HAVE A PERM RATING OF 0.041 U.S. PERMS (0.027 METRIC PERMS) PER ASTM E96 METHOD.
 - THE LINER WILL CONSIST OF A BLENDED LINEAR POLYETHYLENE.
 - THE LINER WILL NOT CONTAIN PLASTICIZERS.

GENERAL EROSION CONTROL AND CONSTRUCTION NOTES

- THE LIMITS OF ALL CLEARING, GRADING AND DISTURBANCE SHALL BE KEPT TO A MINIMUM WITHIN THE PROPOSED AREA OF CONSTRUCTION. ALL AREAS OUTSIDE THE LIMITS OF DISTURBANCE SHALL REMAIN TOTALLY UNDISTURBED.
- INSPECT ALL SEDIMENT AND EROSION CONTROL MEASURES AT LEAST ONCE PER WEEK AND WITHIN 24 HOURS AFTER EVERY RAINFALL EVENT.
- MAINTAIN ALL EROSION AND SEDIMENT CONTROL MEASURES OR REPLACE AS REQUIRED TO ASSURE PROPER FUNCTION.
- CONTRACTOR SHALL IMMEDIATELY REPAIR ANY AND ALL EROSION AND SEDIMENT CONTROLS FOUND TO BE FAULTY.
- ANY AND ALL DEBRIS AND LITTER WHICH ACCUMULATES IN THE BASINS SHALL BE REMOVED WEEKLY.
- THE CONTRACTOR SHALL IMPLEMENT ALL REASONABLE EROSION AND SEDIMENT CONTROLS PRIOR TO THE ACTUAL COMMENCEMENT OF CONSTRUCTION ACTIVITIES INCLUDING THE CLEARING AND/OR GRUBBING OF ANY PORTION OF THE PROPERTY. THESE MEASURES SHALL BE MAINTAINED IN EFFECT THROUGHOUT THE ENTIRE CONSTRUCTION PHASE, OR UNTIL THE SITE HAS BECOME STABILIZED WITH AN ADEQUATE VEGETATIVE COVER.
- SEDIMENT BUILD UP BEHIND FILTERMITT SHALL BE MONITORED AND BE REMOVED WHENEVER IT HAS ACCUMULATED TO FOUR INCHES IN DEPTH.
- CATCH BASINS SHALL BE PROTECTED WITH SILT FILTERS (SILT SACKS). INSPECT SEDIMENT FILTERS AT LEAST ONCE PER WEEK AND WITHIN 24 HOURS AFTER RAINFALL THAT PRODUCES RUNOFF. CLEAN OR REPLACE FILTERS WITHIN 24 HOURS OF INSPECTION WHEN SEDIMENT REACHES ONE HALF OF THE FILTER SACK DEPTH. CATCH BASINS SHALL BE PROTECTED BY SEDIMENT FILTERS THROUGHOUT THE CONSTRUCTION PERIOD AND UNTIL ALL DISTURBED AREAS ARE THOROUGHLY STABILIZED. SUMPS SHALL BE CLEANED WHENEVER SEDIMENT HAS ACCUMULATED TO A DEPTH OF 24 INCHES AND IMMEDIATELY FOLLOWING INSTALLATION OF PERMANENT PAVEMENT.
- THE CONTRACTOR SHALL MAINTAIN AN ADEQUATE STOCKPILE OF EROSION CONTROL MATERIALS ON-SITE AT ALL TIMES FOR EMERGENCY OR ROUTINE REPLACEMENT AND SHALL INCLUDE MATERIALS TO REPAIR OR REPLACE SILT FENCE, MULCH SOCK, STONE FILTER DIKES OR ANY OTHER DEVICES PLANNED FOR USE DURING CONSTRUCTION.
- THE CONTRACTOR IS TO INSPECT ALL CONTROLS NO LESS THAN WEEKLY, AND IN ANTICIPATION OF RAINFALL EVENTS EXPECTED TO EXCEED 1/2 INCH IN DEPTH. ALL DEFICIENCIES NOTED DURING SAID INSPECTION SHALL BE REPAIRED IMMEDIATELY AND IN NO CASE SHALL A DEFICIENCY BE ALLOWED TO GO UNCORRECTED DURING A RAINFALL EVENT. THE EROSION CONTROL DEVICES SHALL BE MAINTAINED, REINFORCED, OR REPLACED IF NECESSARY. ALL ACCUMULATED SEDIMENTS AND OTHER MATERIALS COLLECTED
- BY THE SEDIMENTATION CONTROL SYSTEMS SHALL BE REMOVED AS NECESSARY TO INSURE PROPER FUNCTION OF SYSTEMS AND DISPOSED OF IN A MANNER THAT IS CONSISTENT WITH THE INTENT OF THIS PLAN, IN AN UPLAND AREA.
- TEMPORARY EARTH OR STONE DIKES, DRAINAGE SWALES AND/OR TEMPORARY SLOPE DRAINS SHALL BE INSTALLED WHERE OFF-SITE OR ON-SITE RUNOFF IS SUFFICIENT ENOUGH SUCH THAT IT WILL BE NECESSARY TO DIVERT THE FLOW AROUND THE SITE OR PREVENT EROSION WITHIN THE LIMITS OF WORK.
- STORM DRAIN INLET PROTECTION SHALL BE USED FOR ALL EXISTING AND PROPOSED CATCH BASINS IN THE PROJECT AREA. PRIOR TO COMPLETION OF THE PROJECT, ALL CATCH BASINS WITHIN THE PROJECT AREA SHALL BE CLEANED.
- ALL DISTURBED EARTH SLOPES AREA TO BE STABILIZED WITH PERMANENT VEGETATIVE COVER, TO BE ESTABLISHED AS SOON AS POSSIBLE. DISTURBED AREAS THAT ARE NOT SUBJECT TO CONSTRUCTION TRAFFIC SHALL RECEIVE A PERMANENT OR TEMPORARY VEGETATIVE COVER AS SOON AS FINAL CONTOURS ARE ESTABLISHED. TEMPORARY VEGETATIVE COVER IS TO BE ESTABLISHED ON ALL DISTURBED AREAS WHERE CONSTRUCTION ACTIVITIES WILL NOT REQUIRE ADDITIONAL DISTURBANCE FOR PERIOD OF 30 DAYS OR MORE. IF THE SEASON PREVENTS THE ESTABLISHMENT OF VEGETATIVE COVER, DISTURBED AREAS SHALL BE MULCHED AND THEN SEEDED AS SOON AS WEATHER CONDITIONS ALLOW.
- THERE SHALL BE NO DIRECT DISCHARGE OF DEWATERING OPERATIONS INTO ANY DRAINAGE SYSTEM UNLESS THIS DISCHARGE IS CLEAN AND FREE OF SETTLEABLE SOLIDS. ANY DEWATERING DISCHARGE CONTAINING SETTLEABLE SOLIDS (SEDIMENTS) SHALL BE PASSED THROUGH A SEDIMENTATION CONTROL DEVICE(FILTER BAG) TO REMOVE THESE SOLIDS. THE CONTRACTOR IS TO MAINTAIN SAID SEDIMENT CONTROL DEVICE THROUGHOUT THE ENTIRE DEWATERING OPERATION AND REPAIR DEFICIENCIES IMMEDIATELY.
- SOIL STOCKPILE AREAS FOR CONSTRUCTION MATERIALS SHALL BE LOCATED OUTSIDE WETLAND AREAS AND ASSOCIATED BUFFERS.
- ALL PLANTINGS SHALL BE ACCOMPLISHED BY THE CONTRACTOR AS EARLY AS THE POSSIBLE UPON COMPLETION OF GRADING AND CONSTRUCTION.
- ALL PLANTINGS SHALL BE WATERED AND MAINTAINED BY THE CONTRACTOR TO ENSURE SURVIVAL.
- EROSION CONTROL SHALL REMAIN IN PLACE UNTIL THE CERTIFICATE OF COMPLETION IS ISSUED

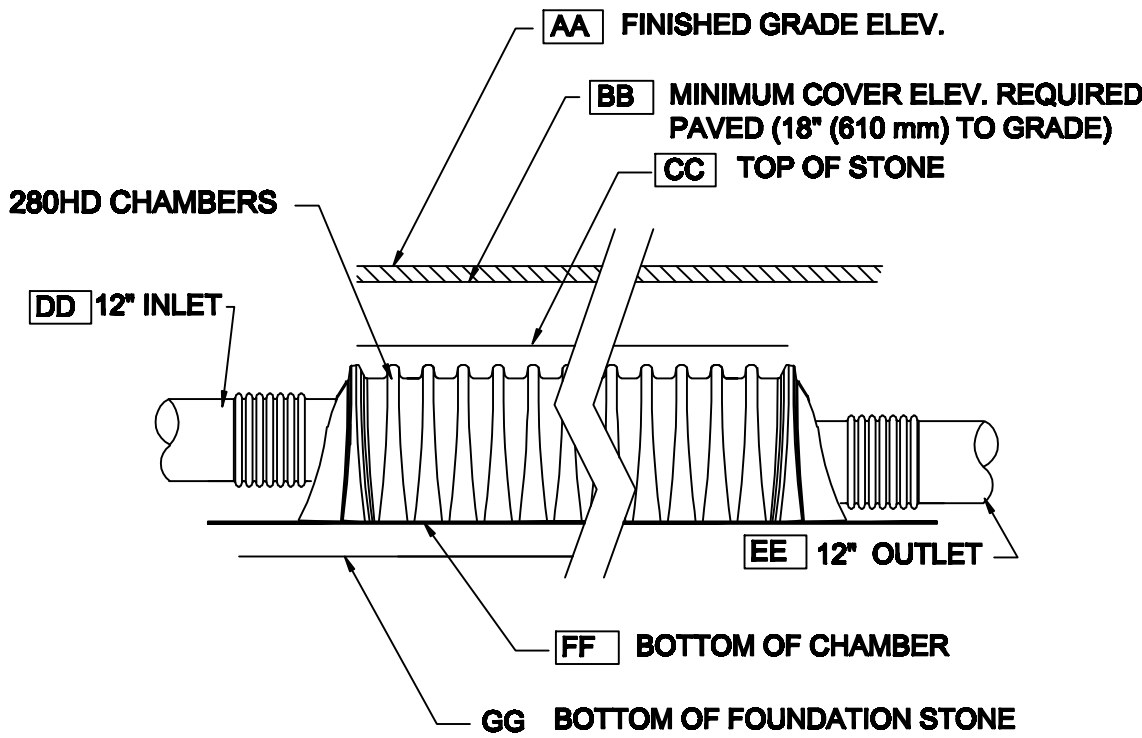

INTERIM EROSION CONTROL AND CONSTRUCTION SEQUENCE

- INSTALL EROSION CONTROL BARRIERS AND HAVE ENGINEER INSPECT AND PREPARE LETTER.
- RAZE THE EXISTING BUILDINGS, PAVEMENT, WALKWAYS, ETC CLEAR SITE OF ALL TREES DESIGNATED TO BE REMOVED.
- CONSTRUCT A TEMPORARY BASIN TO COLLECT RUNOFF DURING CONSTRUCTION.
- STOCKPILE LOAM, OR REMOVE LOAM.
- INSTALL PIPES FOR DRAINAGE SYSTEMS. INSTALL DISCHARGE POINT ON EACH SYSTEM.
- BRING SITE TO SUB-GRADE.
- ALL SLOPES ALONG THE PROPERTY LINES SHALL BE MULCHED TEMPORARILY, IF DISTURBED.
- TEMPORARY STONE (3/4" – 1 1/2") SHALL BE PLACED AT THE PROJECT ENTRANCE WHEN ACCESSING EXISTING PAVEMENT. SWEEPING IS REQUIRED IF FINES ARE OBSERVED IN THE PARKING LOT OR PUBLIC WAYS.
- ALL DISTURBED AREAS NOT TREATED WITH PERMANENT LOAM AND SEED SHALL BE COVERED WITH MULCH, OR OTHER EROSION CONTROL DEVICE.
- ALL CONSTRUCTION GRADES IN THE INTERIM SHALL BE SLOPED TO FLOW INTO THE TEMPORARY BASIN, WHERE POSSIBLE.
- THE SITE MITIGATION OF EROSION IN THOSE AREAS TO BE LANDSCAPED OR MULCHED SHALL BE TO INSTALL AS SOON AS POSSIBLE.
- CLEAN ALL SEDIMENT OUT OF TEMPORARY BASIN AND INSTALL CLEAN FILL PER PLAN SPECIFICATIONS PRIOR TO FINAL GRADING AND SURFACE STABILIZATION.
- THE SUBSURFACE DRAINAGE SYSTEM SHALL BE INSTALLED PRIOR TO PAVEMENT INSTALLATION PROPER FILTERFABRIC SHALL BE PLACED AT INLETS TO KEEP THE STORM DRAINAGE CLEAN OF DEBRIS.
- ONCE THE CURB IS INSTALLED, THE PERMANENT MULCH AND LANDSCAPING SHALL BE INSTALLED.
- SEDIMENT CONTROL SHALL REMAIN IN PLACE UNTIL THE SITE IS STABILIZED.
- CLEAN ALL ON SITE CATCH BASINS, MANHOLES, PIPING, TEMPORARY BASIN, AND INFILTRATION CHAMBERS. INSTALL SILT BAGS AT EACH CATCH BASIN.
- KEEP SITE SWEPT AND MAINTAINED PER STORMWATER MANAGEMENT PLAN.

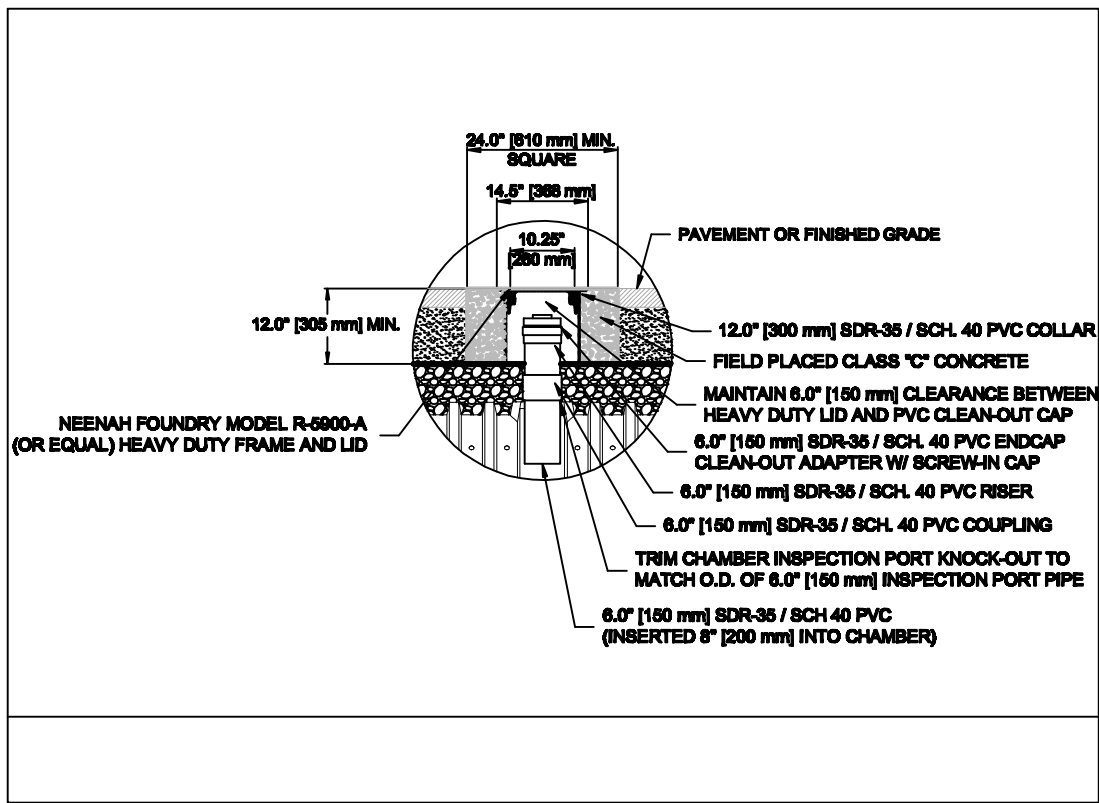

INSPECTION PORT
NOT TO SCALE

	8 UNIT CULTEC RECHARGER 280HD SYSTEM	ELEV.
AA	FINISHED GRADE ELEV.	195.88
BB	MINIMUM COVER ELEV. (PAVEMENT)	195.63
CC	TOP OF STONE	194.96
DD	12" INLET	192.44
EE	12" OUTLET	N/A
FF	BOTTOM OF CHAMBER	192.25
GG	BOTTOM OF FOUNDATION STONE	191.75

ELEVATIONS

	1 UNIT CULTEC RECHARGER 280HD SYSTEM	ELEV.
AA	FINISHED GRADE ELEV.	202.25
BB	MINIMUM COVER ELEV. (GRASS)	202.04
CC	TOP OF STONE	201.21
DD	12" INLET	200.25
EE	12" OUTLET (OVERFLOW SPOUT)	205.50
FF	BOTTOM OF CHAMBER	198.50
GG	BOTTOM OF FOUNDATION STONE	198.00

ELEVATIONS

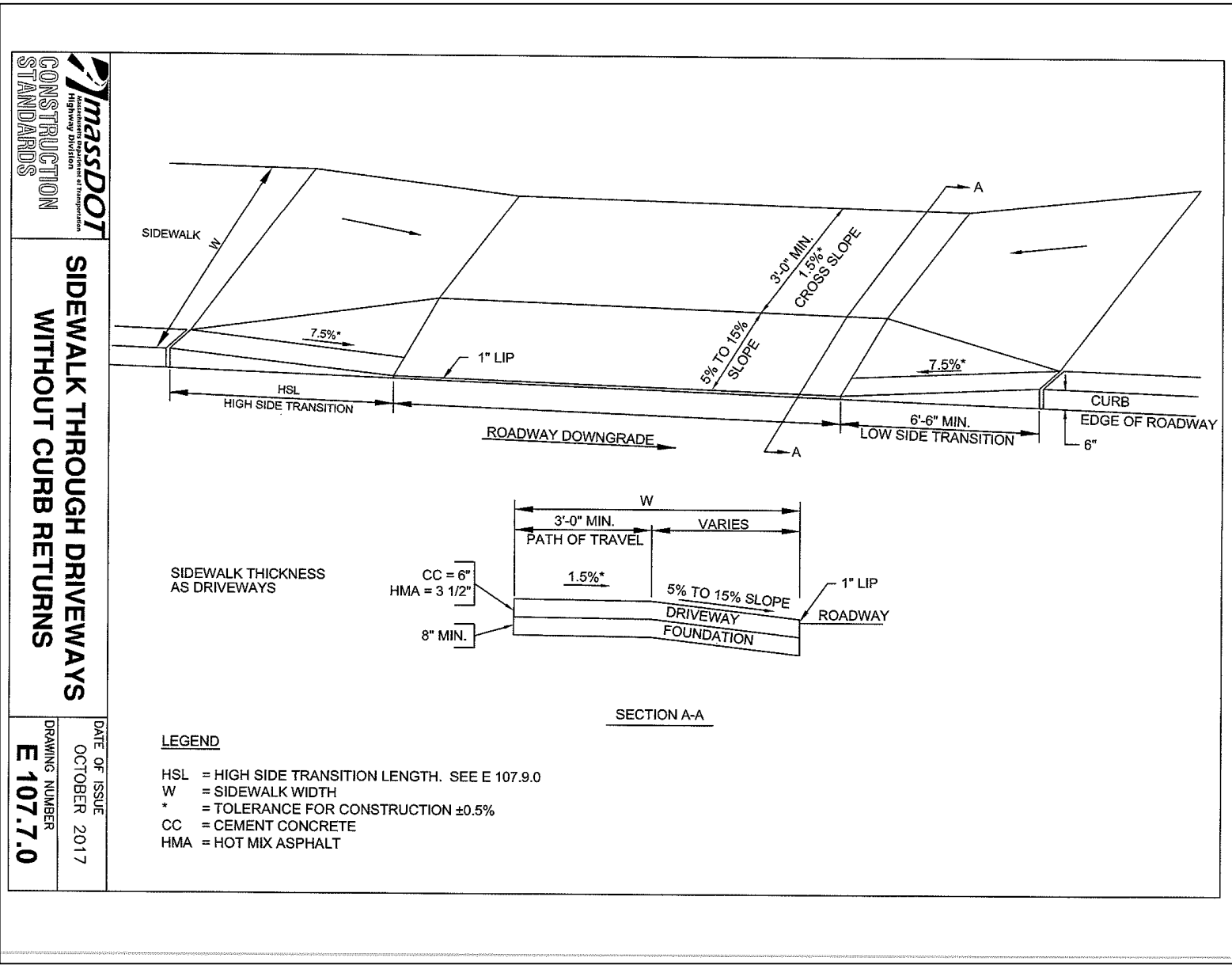
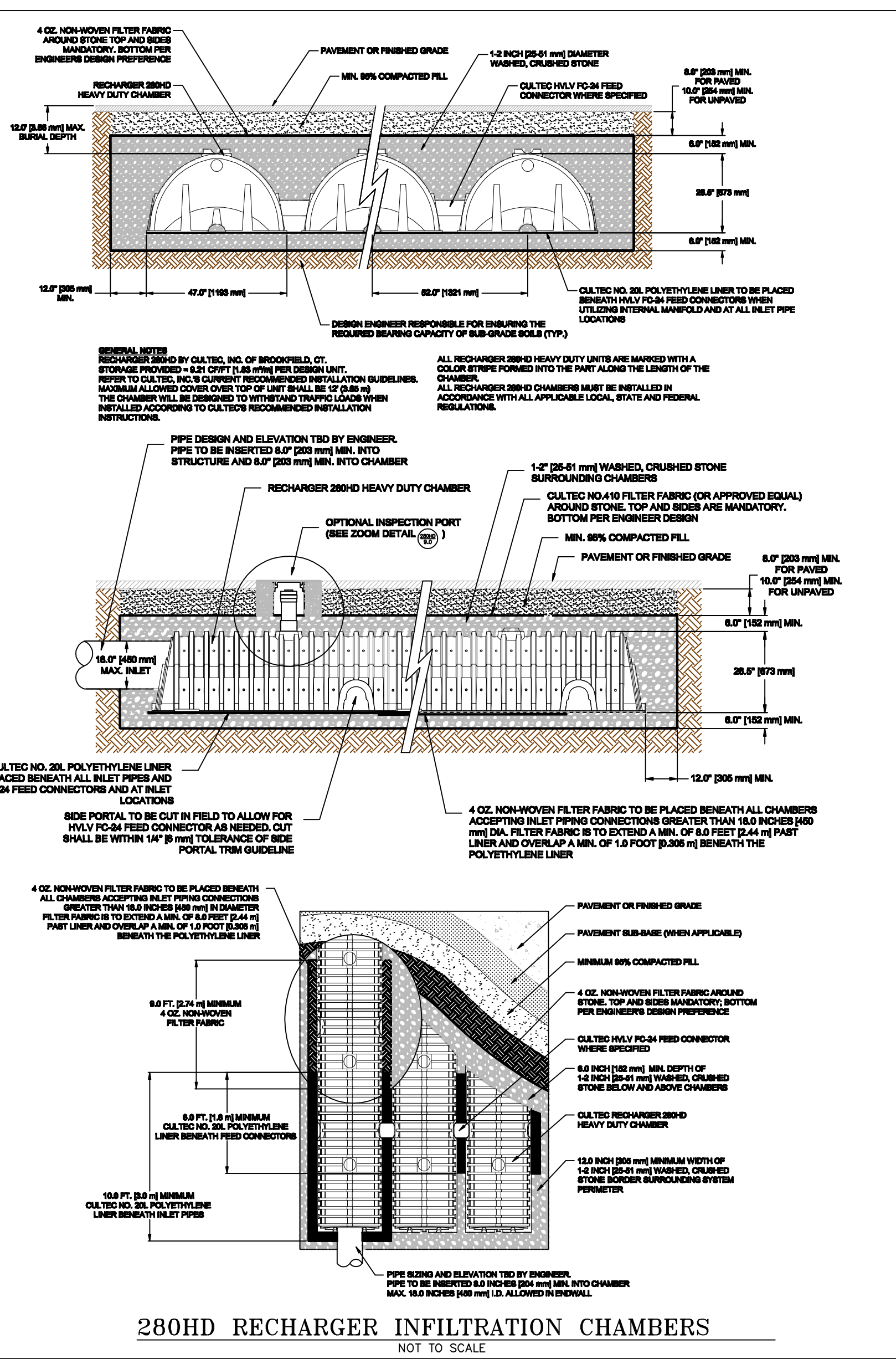

MASSDOT E 107.7.0
SIDEWALK THROUGH DRIVEWAYS
WITHOUT CURB RETURN DETAIL

NOT TO SCALE

JOB NO.
F4137

APPROVED DATE:
PLANNING AND ECONOMIC
DEVELOPMENT BOARD

DATE:
BEING A MAJORITY

PROFESSIONAL
LAND SURVEYOR

PROFESSIONAL
ENGINEER

APPLICANT:
ROBERT CARLUCCI
AND JEFF SWAHN
P.O. BOX F
FRANKLIN, MA. 02038

LOCUS:

143 VILLAGE STREET
A.M. 60 LOT 92
DEED BK 20894 PG 320

REVISIONS

DATE	REVISED
10/10/17	PER TOWN COMMENTS
10/25/17	SIDEWALK, LIGHT SPILLAGE, MASSDOT DETAIL, ISOLATOR ROW, SIGNATURE BLOCKS

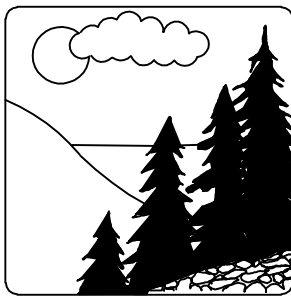

Guerriere
&
Halnon, Inc.

Engineering & Land Surveying
55 WEST CENTRAL STREET
FRANKLIN, MA. 02038
www.guerriereandhalnon.com

CONSTRUCTION DETAILS

AND SPECIAL PERMIT
143 VILLAGE
STREET
MEDWAY
MASSACHUSETTS

DATE
SEPTEMBER 6, 2017

SCALE
1"=10'

SHEET
7 OF 7

JOB NO.
F4158

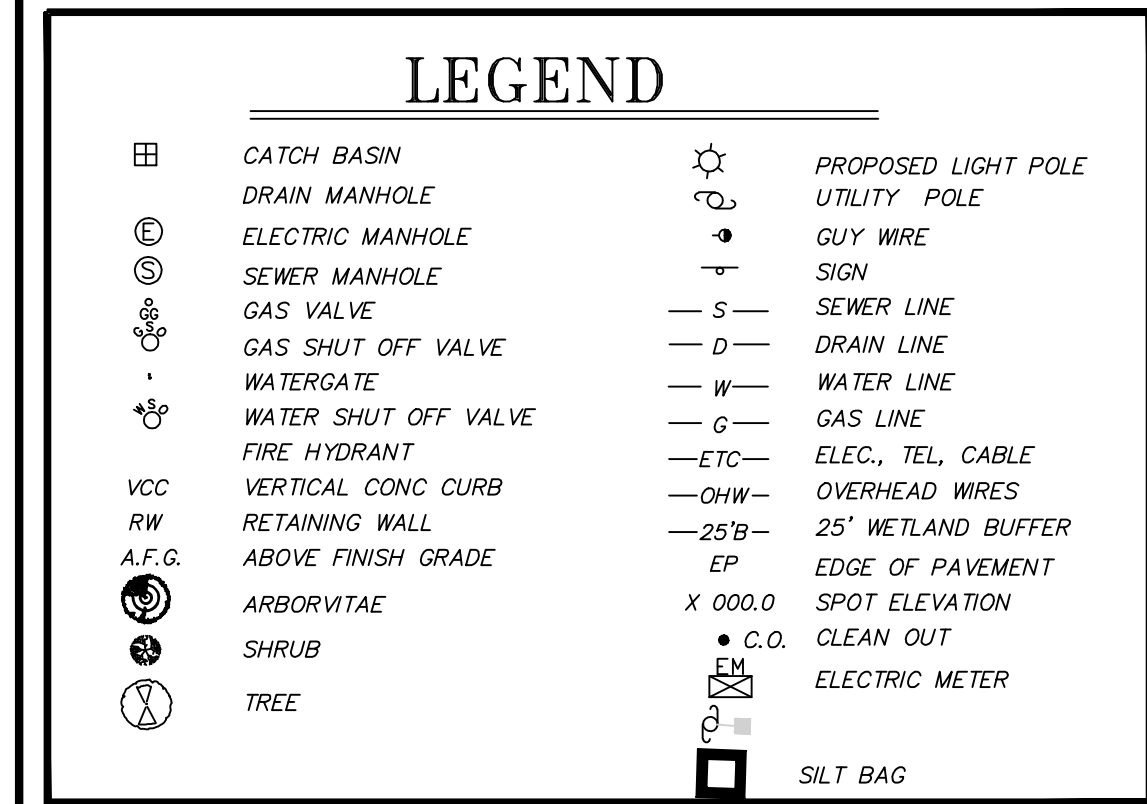

	REQUIRED	EXISTING
AREA	10,000SF	5,868±SF.
FRONTAGE	N/A	N/A
FRONT YARD	20'	13.9'±
SIDE YARD	10'	6.2'±
REAR YARD	10'	N/A
LOT COVERAGE		
BUILDINGS	80%	28%
LOT COVERAGE		
AREA	N/A	N/A

8. THE OWNER/APPLICANT SHALL LIMIT CONSTRUCTION DEBRIS AND MATERIALS ON THE SITE. IN THE EVENT THAT DEBRIS IS CARRIED ONTO A PUBLIC WAY, THE OWNER/APPLICANT SHALL BE RESPONSIBLE FOR ALL CLEANUP OF THE ROADWAY.

1. INSTALL SILT SACKS.
2. BARRIER AROUND CATCH BASIN, MULCH SOCK OR EQUAL
3. INSTALL SILT SACK IN CATCH BASINS UNTIL CONSTRUCTION IS COMPLETE.
4. INSPECTIONS BEFORE AND AFTER STORM EVENTS ARE REQUIRED TO INSURE ADEQUACY OF EROSION CONTROL MEASURES.
5. CONTRACTOR & ARCHITECT ARE TO VERIFY SITE UTILITIES PRIOR TO DESIGN & CONSTRUCTION.
6. THE DESIGNATED ISOLATOR ROW SHALL BE WRAPPED WITH 410 NON-WOVEN GEOTEXTILE AND 66 WOVEN GEOTEXTILE PER MANUFACTURE SPECIFICATION. NO INTERNAL MANIFOLDS TO BE INSTALLED.

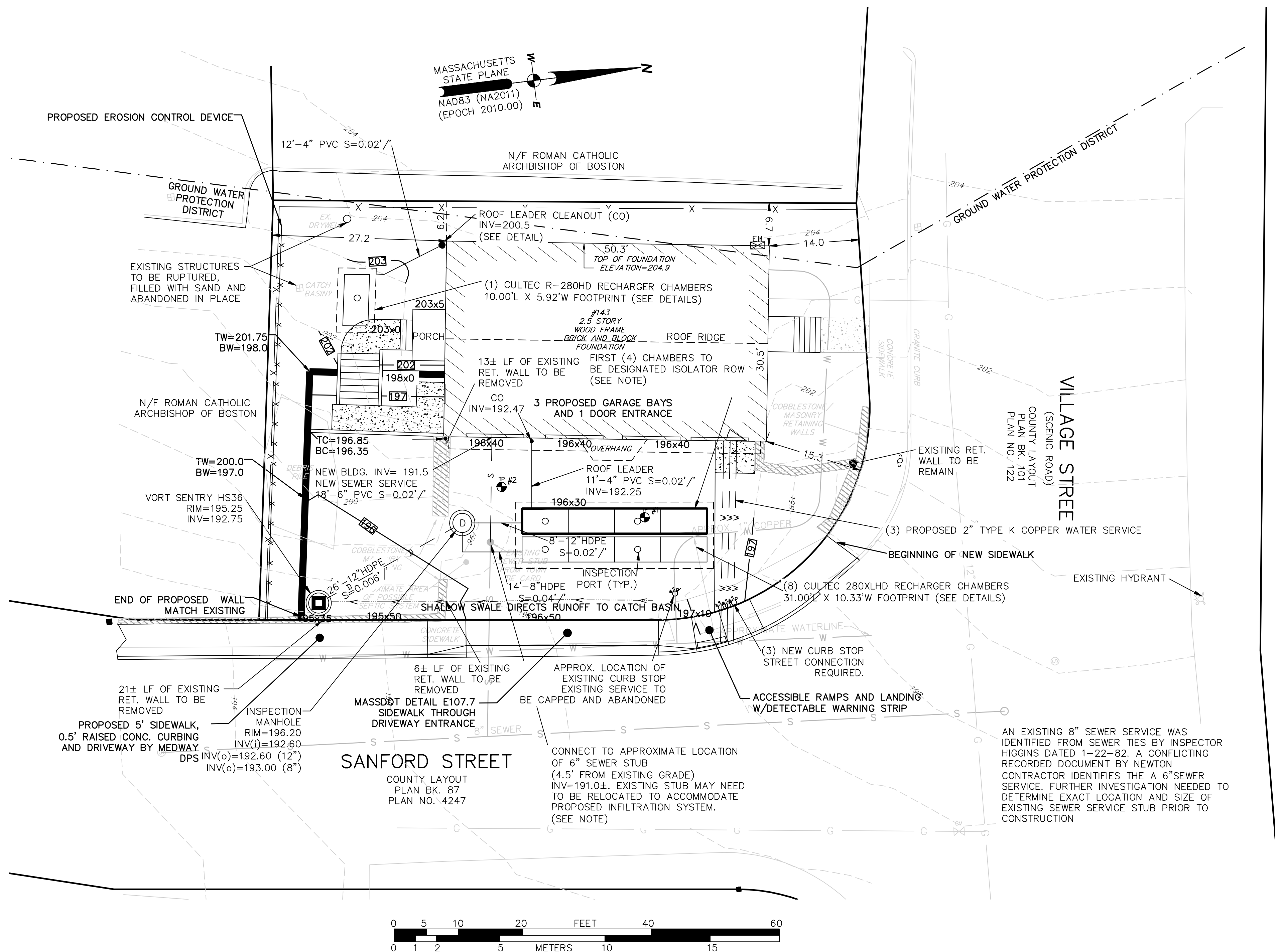

AN EXISTING 8" SEWER SERVICE WAS IDENTIFIED FROM SEWER TIES BY INSPECTOR HIGGINS DATED 1-22-82. A CONFLICTING RECORDED DOCUMENT BY NEWTON CONTRACTOR IDENTIFIES THE A 6"SEWER SERVICE. FURTHER INVESTIGATION NEEDED TO DETERMINE EXACT LOCATION AND SIZE OF EXISTING SEWER SERVICE STUB PRIOR TO CONSTRUCTION

DATE	REVISED
10/10/17	PER TOWN COMMENTS
10/25/17	SIDEWALK, LIGHT SPILLAGE
	ISOLATOR ROW, SIGNATURE BLOCKS



**Guerriere
&
Halnon, Inc.**

Engineering & Land Surveying

55 WEST CENTRAL STREET
FRANKLIN, MA 02038

Ph. (508) 528-3221
Fx. (508) 528-7921

www.gandhengineering.com

MULTI FAMILY HOUSING
SPECIAL PERMIT
143 VILLAGE STREET
MEDWAY
MASSACHUSETTS

DATE SEPTEMBER 6, 2017	SCALE 1"=10'
SHEET 4 OF 7	JOB NO. F4158

JOB NO. F4158

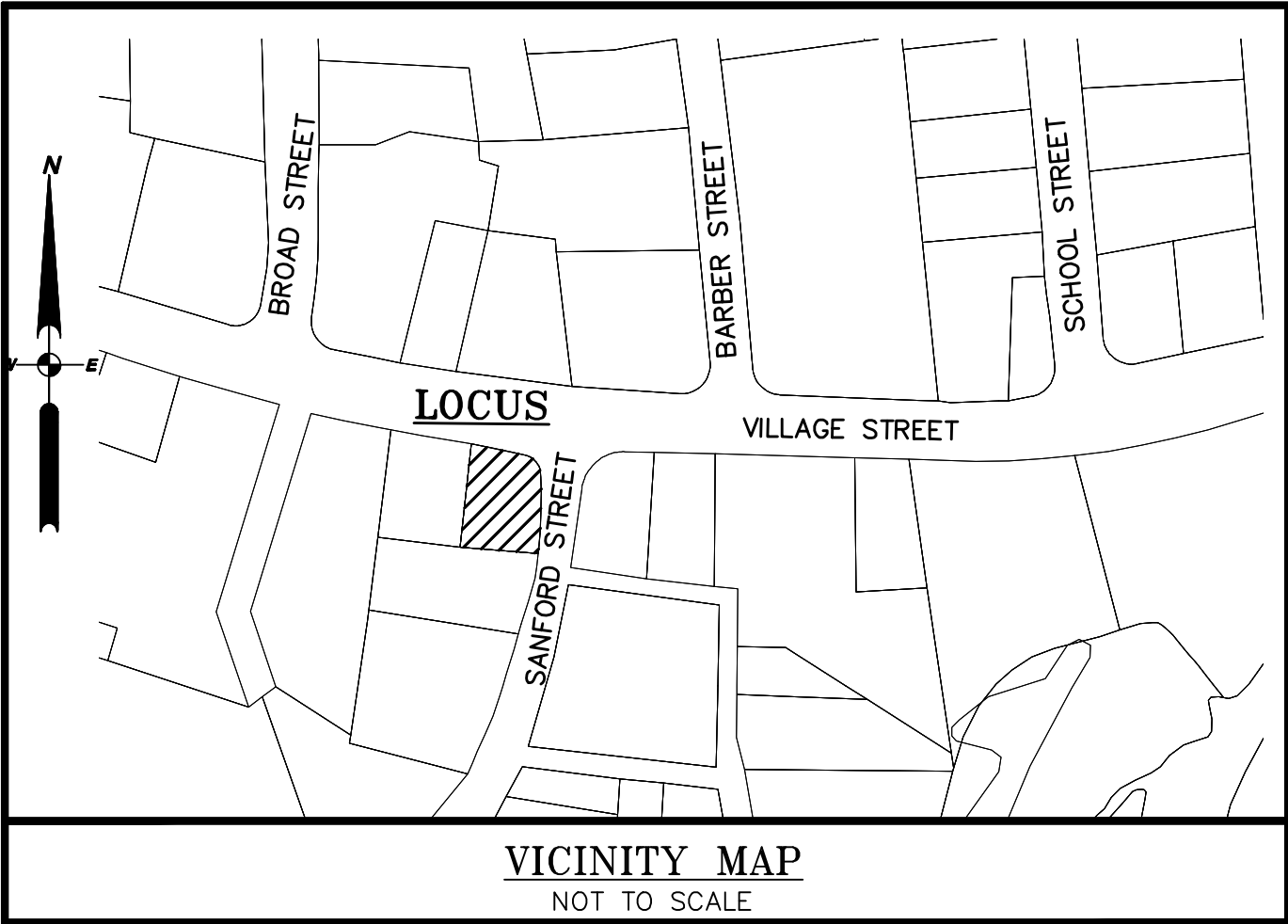

LEGEND

	CATCH BASIN		PROPOSED LIGHT POLE
	DRAIN MANHOLE		UTILITY POLE
	ELECTRIC MANHOLE		GUY WIRE
	SEWER MANHOLE		SIGN
	GAS VALVE		SEWER LINE
	GAS SHUT OFF VALVE		DRAIN LINE
	WATERGATE		WATER LINE
	WATER SHUT OFF VALVE		GAS LINE
	FIRE HYDRANT		ELEC., TEL. CABLE
	VERTICAL CONC CURB		OVERHEAD WIRES
	RETAINING WALL		25' WETLAND BUFFER
	ABOVE FINISH GRADE		EDGE OF PAVEMENT
	ARBORVITAE		SPOT ELEVATION
	SHRUB		CLEAN OUT
	TREE		ELECTRIC METER
			SILT BAG

ZONING INFORMATION
VILLAGE COMMERCIAL

	REQUIRED	EXISTING
AREA	10,000SF	5,868±SF.
FRONTAGE	N/A	N/A
FRONT YARD	20'	13.9'±
SIDE YARD	10'	6.2'±
REAR YARD	10'	N/A
LOT COVERAGE		
BUILDINGS	80%	28%
LOT COVERAGE		
AREA	N/A	N/A

NOTES

- THIS LAND IS ZONED VILLAGE COMMERCIAL
- THIS LAND IS WITHIN THE MEDWAY VILLAGE OVERLAY DISTRICT.
- THIS SITE IS NOT IN A FLOOD HAZARD ZONE.
- THE CONTRACTOR SHALL VERIFY THE LOCATION OF ALL UTILITIES IN THE FIELD. ANY DISCREPANCY WITH THE PLANS SHOULD BE REPORTED TO THE DESIGN ENGINEER UPON DISCOVERY.
- REFER TO MEDWAY ASSESSORS MAP 60 LOTS 092.
- VILLAGE STREET IS DESIGNATED AS A SCENIC ROAD.
- THE NORTH WESTERLY PORTION OF THE LOT IS WITHIN THE GROUND WATER PROTECTION DISTRICT.
- ALL EROSION CONTROL DEVICES SHALL BE IN PLACE PRIOR TO CONSTRUCTION.
- THE OWNER/APPLICANT SHALL LIMIT CONSTRUCTION DEBRIS AND MATERIALS ON THE SITE. IN THE EVENT THAT DEBRIS IS CARRIED ONTO A PUBLIC WAY, THE OWNER/APPLICANT SHALL BE RESPONSIBLE FOR ALL CLEANUP OF THE ROADWAY.

UTILITIES ARE PLOTTED AS A COMPILATION OF RECORD DOCUMENTS, MARKINGS, AND OTHER OBSERVED EVIDENCE TO DEVELOP A VIEW OF THE UNDERGROUND UTILITIES AND SHOULD BE CONSIDERED APPROXIMATE. LACKING EXCAVATION, THE EXACT LOCATION OF UNDERGROUND FEATURES CANNOT BE ACCURATELY COMPLETELY AND RELIABLY DEPICTED. ADDITIONAL UTILITIES, NOT EVIDENCED BY RECORD DOCUMENTS OR OBSERVED PHYSICAL EVIDENCE, MAY EXIST. CONTRACTORS (IN ACCORDANCE WITH MASS.G.L. CHAPTER 82 SECTION 40 AS AMENDED) MUST CONTACT ALL UTILITY COMPANIES BEFORE EXCAVATING AND DRILLING AND CALL DIGSAFE AT 1(888)DIG-SAFE(7233).

CONSTRUCTION ON THIS LAND IS SUBJECT TO ANY EASEMENTS, RIGHTS-OF-WAY, RESTRICTIONS, RESERVATIONS, OR OTHER LIMITATIONS WHICH MAY BE REVEALED BY AN EXAMINATION OF THE TITLE.

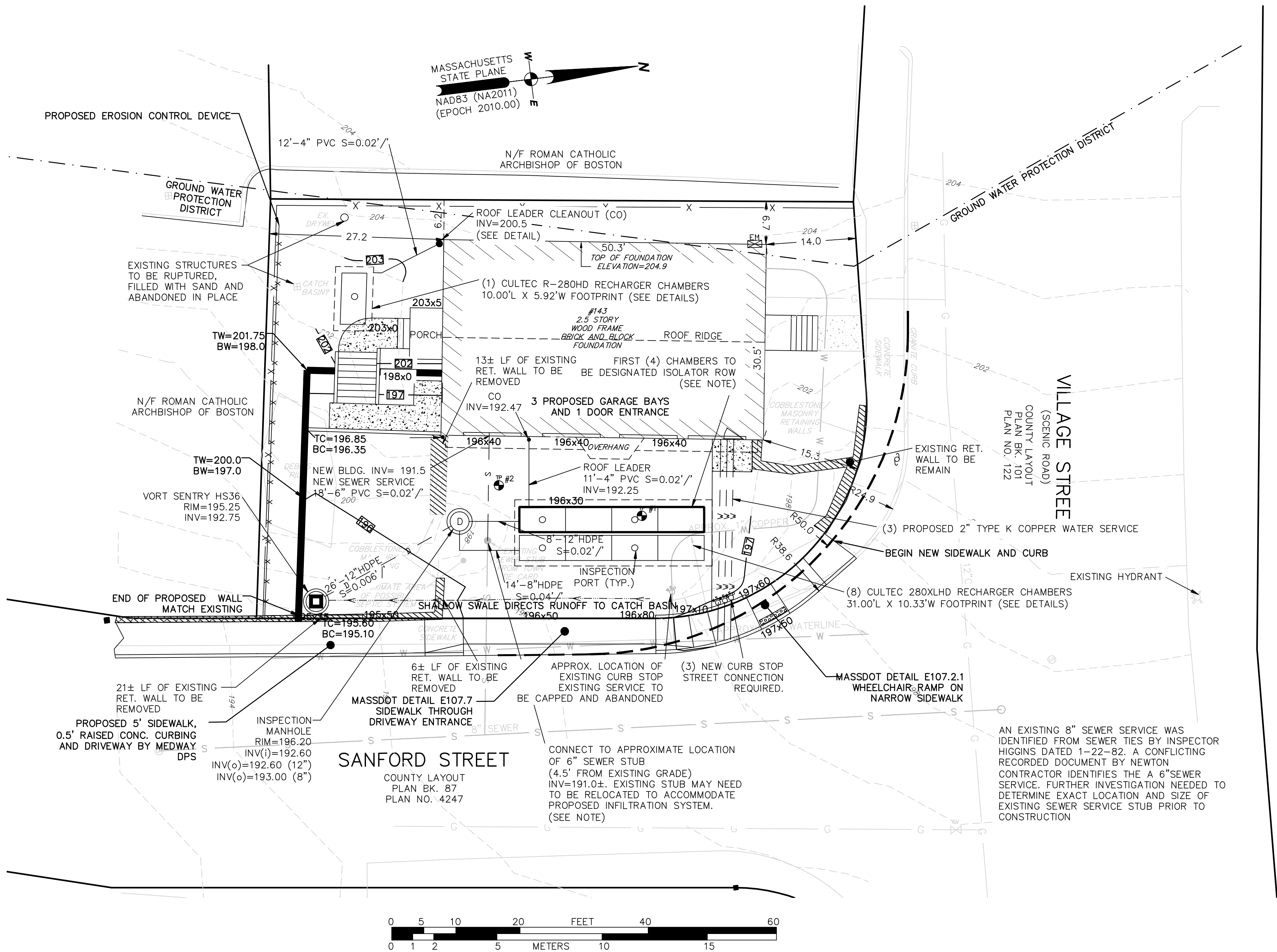

STORM DRAINAGE NOTES

SPECIAL CONSIDERATION FOR INLET CONTROLS FOR EROSION COLLECTION BEFORE ENTERING DRAINAGE SYSTEM:

- INSTALL SILT SACKS.
- BARRIER AROUND CATCH BASIN, MULCH SOCK OR EQUAL
- INSTALL SILT SACK IN CATCH BASINS UNTIL CONSTRUCTION IS COMPLETE.
- INSPECTIONS BEFORE AND AFTER STORM EVENTS ARE REQUIRED TO INSURE ADEQUACY OF EROSION CONTROL MEASURES.
- CONTRACTOR & ARCHITECT ARE TO VERIFY SITE UTILITIES PRIOR TO DESIGN & CONSTRUCTION.
- THE DESIGNATED ISOLATOR ROW SHALL BE WRAPPED WITH 410 NON-WOVEN GEOTEXTILE AND 66 WOVEN GEOTEXTILE PER MANUFACTURE SPECIFICATION. NO INTERNAL MANIFOLDS TO BE INSTALLED.

JOB NO. **F4158**

APPROVED DATE: _____
PLANNING AND ECONOMIC DEVELOPMENT BOARD

DATE: _____
BEING A MAJORITY

PROFESSIONAL LAND SURVEYOR _____
PROFESSIONAL ENGINEER _____

OWNER: VIRGINIA I. HEAVEY
6 SANFORD STREET
MEDWAY, MA 02053
DEED BK. 20894 PG. 320

APPLICANT: N.E. PREMIER PROPERTIES, LLC
KEVIN TUCCERI, MANAGER
5 SHIELA LANE
FRANKLIN, MA 02038

LOCUS:
143 VILLAGE STREET
A.M. 60 LOT 92

REVISIONS

DATE	REVISED
10/10/17	PER TOWN COMMENTS
10/25/17	SIDEWALK, LIGHT SPILLAGE, MASSDOT DETAIL
	ISOLATOR ROW, SIGNATURE BLOCKS

Guerriere & Halnon, Inc.
Engineering & Land Surveying
Ph. (508) 528-3221
Fx. (508) 528-7921
www.gandhengineering.com

GRADING, UTILITY AND EROSION CONTROL PLAN

MULTI FAMILY HOUSING
SPECIAL PERMIT
143 VILLAGE STREET
MEDWAY
MASSACHUSETTS

DATE: **SEPTEMBER 6, 2017**
SHEET: **4 OF 7**

SCALE: **1"=10'**
JOB NO. **F4158**

0.02 W FOOTPRINT (SEE DETAILS)

#143
2.5 STORY
WOOD FRAME
BRICK AND BLOCK
FOUNDATION

ROOF RIDGE

OF EXISTING
L TO BE

FIRST (4) CHAMBERS TO
BE DESIGNATED ISOLATOR ROW
(SEE NOTE)

3 PROPOSED GARAGE BAYS
AND 1 DOOR ENTRANCE

196x40

196x40

OVERHANG
ROOF LEADER
11'-4" PVC S=0.02'/'
INV=192.25

196x30

8'-12" HDPE
S=0.02'/'

INSPECTION
PORT (TYP.)

8" HDPE
S=0.04'/'
JECTS RUNOFF TO CATCH BASIN

196x50

196x80

197x40

197x60

197x50

30.5'

202

15.3

198

R50.0

R38.6

(8) CULTEC 280XLHD RECHARGER CHAMBERS
31.00'L X 10.33'W FOOTPRINT (SEE DETAILS)

EXISTING RET.
WALL TO BE
REMAIN

(3) PROPOSED 2" TYPE K COPPER W

BEGIN NEW SIDEWALK AND CURB

(3) NEW CURB STOP
STREET CONNECTION
REQUIRED.

MASSDOT DETAIL E107.2.1
WHEELCHAIR RAMP ON
NARROW SIDEWALK

APPROX. LOCATION OF
EXISTING CURB STOP
EXISTING SERVICE TO
BE CAPPED AND ABANDONED

VILLAGE SIREE
(SCENIC ROAD)
COUNTY LAYOUT
PLAN BK. 101
PLAN NO. 122



TOWN OF MEDWAY
Planning & Economic Development Board
155 Village Street
Medway, Massachusetts 02053

*Andy Rodenhiser, Chairman
Robert K. Tucker, Vice-Chairman
Thomas A. Gay, Clerk
Matthew J. Hayes, P.E.
Richard Di Iulio*

October 27, 2017 – DRAFT

**MULTIFAMILY HOUSING & GROUNDWATER PROTECTION DISTRICT
SPECIAL PERMIT and SITE PLAN DECISION**
143 Village Street
with Waivers and Conditions

Decision Date: October 30, 2017

Project Location: 143 Village Street

Name/Address of Applicant: N.E. Premier Properties, LLC
5 Sheila Lane
Franklin, MA 02038

Name/Address of Property Owner: Estate of Virginia Heavey
6 Sanford Street
Medway, MA 02038

Engineer: Dale MacKinnon, P.E.
Guerriere & Halnon
55 West Central Street
Franklin, MA 02038

Architect: James Gilmour
JG Architecture
200 Winter Street
Holliston, MA 01746

Site Plan: *Multi Family Housing Special Permit – 143 Village Street*
Dated September 6, 2017, last revised October 10, 2017

Assessors' Reference: 60 – 92

Zoning District: Village Commercial
Multifamily Housing Overlay District
Adaptive Use Overlay District
Groundwater Protection Overlay District

I. PROJECT DESCRIPTION – The applicant plans to develop a 3 unit, residential condominium in the existing building at 143 Village Street. The parcel is located at the southwest corner of Village and Sanford Streets in the Village Commercial zoning district. The 5,868 sq. ft. site (*Medway Assessors Map 60, Parcel 92*) is currently owned by the Estate of Virginia Heavey. This is a pre-existing, non-conforming parcel which includes a building constructed in 1910. The building is also pre-existing, non-conforming in terms of zoning setbacks on the property. The property is also located within the Town’s multifamily housing overlay district, adaptive use overlay district, and the groundwater protection district.

The proposed redevelopment of the existing building will include three dwelling units. Six parking spaces will be provided – 3 under the building and 3 surface. Vehicular access will be from Sanford Street. Stormwater management facilities will be installed on site as will landscaping, walkways, and retaining walls. The *Multi Family Housing Special Permit 143 Village Street* site plan is dated September 6, 2017, last revised October 10, 2017 and was prepared by Guerriere and Halnon of Franklin, MA

The proposed use and location require a groundwater protection district special permit pursuant to Section 5.6.3 of the *Medway Zoning Bylaw* and a multifamily housing special permit pursuant to Section 5.6.4 along with site plan review and approval pursuant to Section 3.5.

II. VOTE OF THE BOARD – After reviewing the application and information gathered during the public hearing and review process, the Medway Planning and Economic Development Board, on October 30, 2017, on a motion made by _____ and seconded by _____, voted to _____ with CONDITIONS a multifamily housing and groundwater protection district special permit and to _____ with WAIVERS and CONDITIONS as specified herein, a site plan for the construction of a three unit, condominium development on the property at 143 Village Street as shown on the plan titled *Multi Family Housing Special Permit – 143 Village Street*, dated September 6, 2017, last revised October 10, 2017, drawn by Guerriere and Halnon of Franklin, MA, to be further revised as specified herein before endorsement and recording.

The motion was _____ by a vote of _____ in favor and _____ opposed.

Planning & Economic Development Board Member

Vote

Richard Di Iulio
Matthew Hayes
Thomas A. Gay
Andy Rodenhiser
Robert Tucker

III. PROCEDURAL HISTORY

- A. September 6, 2017 – Application for special permit and site plan and associated materials filed with the Medway Planning & Economic Development Board and the Medway Town Clerk
- B. September 7, 2017 – Public hearing notice filed with the Town Clerk and posted at the Town of Medway web site.
- C. September 13, 2017 – Site plan information distributed to Town boards, committees and departments for review and comment.

- D. September 11, 2017 - Public hearing notice mailed to abutters by certified sent mail.
- E. September 12 & 18, 2017 - Public hearing notice advertised in *Milford Daily News*.
- F. September 26, 2017 - Public hearing commenced. The public hearing was continued to October 24 and again to October 30th, when the hearing was closed and a decision rendered.

IV. INDEX OF SITE PLAN DOCUMENTS

- A. The special permit application for the proposed development included the following plans, studies and information that were provided to the Planning and Economic Development Board at the time the application was filed on September 6, 2017.
 - 1. Multifamily Housing Special Permit application dated September 6, 2017 with Project Description, certified abutters' list, property ownership documentation, ZBA permit from October 2004, Groundwater protection district calculations dated September 6, 2017, and purchase and sale agreement dated August 11, 2017.
 - 2. *Multi Family Housing Special Permit – 143 Village Street* site plan dated September 6, 2017, prepared by Dale MacKinnon, P.E. of Guerriere & Halnon, Inc. of Franklin, MA.
 - 3. *Pre-Post Development Stormwater Narrative for 143 Village Street* prepared by Dale MacKinnon, P.E. of Guerriere & Halnon, Inc. of Franklin, MA dated September 6, 2017.
 - 4. Architectural drawings/floor plans dated 9/6/17 by JG Architects of Holliston, MA.
- B. During the course of the review, revised plans and a variety of other materials were submitted to the Board by the applicant and its representatives:
 - 1. Property Owner's authorization letter dated 9/9/17 allowing applicant to seek development permits.
 - 2. *Multi Family Housing Special Permit – 143 Village Street* site plan dated September 6, 2017, last revised October 10, 2017 prepared by Dale MacKinnon, P.E. of Guerriere & Halnon, Inc. of Franklin, MA
 - 3. Requests for Waivers of the *Medway Site Plan Rules and Regulations*, prepared by Dale MacKinnon, P.E. of Guerriere and Halnon, dated September 7, 2017, October 10, 2017 and October 24, 2017
 - 4. Colonial Fencing brochure
 - 5. Techo-Bloc Stone brochure
 - 6. Guerriere & Halnon response letter dated 10/10/17 to the 9/19/17 Tetra Tech review letter.
 - 7. Guerriere & Halnon response letter dated 10/10/17 to the 9/19/17 PGC Associates review letter.
 - 8. Updated *Pre-Post Development Stormwater Narrative for 143 Village Street* prepared by Dale MacKinnon, P.E. of Guerriere & Halnon, Inc. of Franklin, MA, received October 10, 2017

9. Car turning exhibit dated 10/10/17, prepared by Guerriere & Halnon, Inc. of Franklin, MA

10. xxxxxx

C. Other Documentation Entered Into the Record

1. Design Review Committee review letter dated 9/20/17.
2. Review memorandum dated 9/18/17 from Fire Chief Jeff Lynch
3. Review comment letter dated 9/26/17 from Medway Police Sergeant Jeff Watson.
4. Tetra Tech plan review letter dated 9/19/17, revised 10/18/17.
5. PGC plan review letter dated 9/19/17, revised 10/19/17.

V. **TESTIMONY** - In addition to the site plan application materials as submitted and provided during the course of our review, the Planning and Economic Development Board heard and received verbal or written testimony from:

- Sean Reardon, P.E. of Tetra Tech, Inc., the Town's Consulting Engineer – Site plan review letters dated 9/19/17 and 10/18/17 and commentary provided throughout the public hearing process.
- Gino Carlucci, PGC Associates, the Town's Consulting Planner – Site plan review letters dated 9/19/17 and 10/19/17, and commentary provided throughout the public hearing process.
- Danell Baptiste, project engineer from Guerriere & Halnon for the applicant
- Dale MacKinnon, P.E. from Guerriere & Halnon for the applicant
- Rev. Msgr. Timothy Moran, St. Joseph's Catholic Church

VI. **FINDINGS**

The Planning and Economic Development Board, at its meeting on October 30, 2017, on a motion made by _____, and seconded by _____, voted to _____ the following **FINDINGS** regarding the site plan and special permit application for 143 Village Street. The motion was _____ by a vote of ____ in favor and _____ opposed.

MULTIFAMILY HOUSING SPECIAL PERMIT FINDINGS - The Board makes the following findings in relation to this application's compliance with Section 5.6.4 Multifamily Housing of the *Medway Zoning Bylaw*.

- 1) The subject property, located at 143 Village Street, is located within the Multifamily Housing Overlay District and therefore is eligible for a multifamily housing special permit. The site has more than 50' of frontage on Village Street and Sanford Street and therefore complies with the *Zoning Bylaw* requirement for a minimum of 50 feet of frontage on an existing street located within the Multifamily Housing Overlay District.
- 2) Village Street and Sanford Street have sufficient capacity to accommodate the additional traffic flow to be generated by three additional housing units in the subject development.
- 3) The size of the subject parcel is 5,868 sq. ft. It is a pre-existing, nonconforming parcel which does not meet the minimum lot size of 10,000 sq. ft. for the Village

Commercial District. The setbacks also do not comply with those of the underlying zoning district (20' front and 10' side). However, as authorized by Section 5.6.4 C. 1. of the *Zoning Bylaw*, and for the purpose of this application, the Board hereby adjusts the setbacks and allowable minimum lot size. Further, this pre-existing, nonconforming building is eligible for a multifamily housing special permit as there is no increase in the building's dimensional nonconformity and the project can meet the open space and parking requirements of Section 5.6.4.

- 4) The 38' height of the pre-existing building is not proposed to be increased, so therefore complies with the maximum building height of 40'
- 5) The maximum density for a multifamily housing project is 12 units/acre before any density bonus. With its size of .1347 acres, the site is eligible for 1.6 dwelling units. The proposed development includes the rehabilitation of a 100+ year old building and the complete interior reconstruction of 2,858 sq. ft. for 3 residential units, so it qualifies for density bonuses offered in Section 5.6.4. The Affordable Housing requirements of Section 8.6 of the *Zoning Bylaw* do not apply to this development because of its small number of dwelling units. Therefore, the proposed 3 unit development complies with the density requirements of Section. 5.6.4.
- 6) 37% percent of the site is open yard area which meets the minimum required amount of 15%.
- 7) With 6 parking spaces, the project meets the requirements for 1.5 off-street parking spaces per unit plus .5 off-street parking spaces for visitor parking for every 2 dwelling units.
- 8) Town water and sewer service is presently available in both Village and Sanford Streets adjacent to the subject property.
- 9) The Multifamily Housing section of the *Zoning Bylaw* (Section 5.6.4) was first adopted by the Town in 2015 to encourage the provision of a diversity of housing types, to promote pedestrian oriented development, and to increase the number of affordable housing units in Medway. This development will include three apartment style condominium dwelling units to add much needed supply to Medway's housing stock. The site's location is within the Medway Village Commercial District and includes ready access to the Charles River, Town Hall and local convenience retail.
- 10) The 2009 Medway Master Plan encourages the provision of a diversity of housing options for households of all incomes and backgrounds. The amendment of the *Zoning Bylaw* in 2015 to add Section 5.6.4 Multifamily Housing under which this development is proposed is a direct response to the Master Plan housing goal #4 to provide needed changes to the *Zoning Bylaw*. The 2016 Medway Housing Production plan promotes the use of *Zoning Bylaw* provisions for the development of multifamily housing in appropriate locations. The 143 Village Street development is an outstanding example of a modest scale multifamily housing development for Medway's Village Commercial District and the Medway Village Historic District.

- 11) The location of the 143 Village Street development is within the Village Commercial Zoning District and the multifamily use is allowed by special permit under Section 5.6.4 of the *Zoning Bylaw*. The site is nearby other multifamily buildings/developments (50+ units in Sanford Mill). The Board finds that this development is suitably located, is not detrimental to the neighborhood and does not significantly alter the character of the zoning district.

SITE PLAN RULES AND REGULATIONS FINDINGS – The Planning and Economic Development Board shall determine whether the proposed development is in conformance with the standards and criteria set forth in the *Site Plan Rules and Regulations*, unless specifically waived. In making its decision, the Planning and Economic Development Board shall determine the following:

- 12) Has internal circulation, queuing and egress been designed such that traffic safety is protected, access via minor streets servicing residential areas is minimized, and traffic backing up into the public way is minimized?
The site is situated at the southwest corner of Village and Sanford Streets. Access/egress is from Sanford Street only, so no minor streets are impacted. The parking spaces are all internal to the site – 3 surface and 3 within the building. Pursuant to Specific Condition # _____, no vehicular backing onto a public way is allowed.
- 13) Does the site plan show designs that minimize any departure from the character, materials, and scale of buildings in the vicinity as viewed from public ways and places?
The designs of the site and building have been reviewed by the Design Review Committee, a review letter has been provided and the applicant has incorporated the recommendation changes. The setbacks of the building are comparable to others in the area and the materials and scale are appropriate for the site.
- 14) Is reasonable use made of building location, grading and vegetation to reduce the visible intrusion of structures, parking areas, outside storage or other outdoor service areas (e.g. waste removal) from public views or from (nearby) premises residentially used and zoned.
The building is located close to both Village and Sanford Streets with a grass area along the southern portion of the site. The stormwater management areas are located under the parking area and under the grass/yard area in the southwest portion of the site. There is no dumpster planned; each unit will have its own individual trash receptacles that will be stored indoors. A fence shall be installed along the western and southern boundaries of the site.
- 15) Is adequate access to each structure for fire and service equipment provided?
The site is situated at the southwest corner of Village and Sanford Streets. The St. Joseph's Church parking lot is immediately adjacent to the west of the subject site. The Fire Chief has reviewed the plans and determined that there is adequate access for fire and emergency service equipment.
- 16) Will the design and construction minimize, to the extent reasonably possible, the following environmental impacts?
 - a) the volume of cut and fill;

- b) the number of trees to be removed with particular care taken with mature trees and root systems;
- c) the visual prominence of man-made elements not necessary for safety;
- d) the removal of existing stone walls;
- e) the visibility of building sites from existing streets;
- f) the impacts on waterways and environmental resource areas;
- g) soil pollution and erosion;
- h) noise.

Since the project involves the renovation of an existing building on an already developed site, the impacts listed above are minimal. Cuts and fills are the minimum needed to expand the driveway. No significant trees are being removed, a portion of an existing stone wall is being removed to improve safe access to the site, the existing building is highly visible from the street but is being renovated and the aesthetics improved, a stormwater management system ensures minimal impacts on waterways and environmental resources, the minimal disturbance keeps soil pollution and erosion to a minimum, and the impact of construction noise will be minimized with limits on the hours of construction activity. (See General Condition _____).

- 17) Is pedestrian and vehicular safety both on the site and egressing from it maximized?

The site has been designed with an entrance/egress only on Sanford Street. The driveway width meets the minimum required by the Fire Chief. The southbound sight distance from the driveway is acceptable. The northbound sight distance is limited due to the driveway's location of _____ feet to the intersection of Village and Sanford Street. During the course of review, the driveway location was adjusted southerly and reduced in width to the maximum extent possible from 36' to 30'. The project was reviewed for pedestrian and vehicular safety by the Fire Chief and the Town's Consulting Engineer and found to be adequate with Specific Condition _____ prohibiting rear facing vehicular exits from the premises onto Sanford Street. The sidewalk on Sanford Street will be reconstructed by the Town during the fall of 2017 and will enhance pedestrian access and safety.

- 18) Does the design and will the construction incorporate, to the maximum extent possible, the visual prominence of natural and historic features of the site?

While the site has no visually prominent natural features on it, its location is visually prominent at the corner of Village and Sanford Streets within the Medway Village National Register Historic District. The construction will result in an improved appearance due to both renovation of the building and the addition of landscaping to the site.

- 19) Does the lighting of structures and parking area avoid glare on adjoining properties and minimize light pollution within the town?

The lighting plan has been adjusted from the original proposal. Specific Condition #_____ ensures that there is no light glare outside the property boundaries.

- 20) Is the proposed limit of work area reasonable and does it protect sensitive environmental and/or cultural resources? The site plan as designed should not

cause substantial or irrevocable damage to the environment, which damage could be avoided or ameliorated through an alternative development plan or mitigation measures.

The limit of work will encompass the entire site. Given the size and location of the site, this is reasonable. The primary environmental concern is stormwater runoff, and the site generally meets state and local stormwater management regulations. The building will be serviced by Town water and sewer. Any other environmental impacts will be less than would be expected from 3 single family houses on individual lots.

ADAPTIVE USE OVERLAY DISTRICT SITE STANDARDS – Section 5.6.4.B.1 of the *Zoning Bylaw* requires that multifamily housing developments that are located within the boundaries of Medway’s Adaptive Use Overlay District (AUOD) also meet the Adaptive Use Site Development Standards which are articulated in Section 504-4 of the *AUOD Rules and Regulations*. The property located at 143 Village Street is located within the AUOD. The Board makes the following findings in relation to this application’s compliance with the AUOD Site Development Standards.

- 21) Standard 504-4 B provides that an existing building must be restored or renovated to maintain, restore or enhance its architectural integrity. *The building is being completely renovated to create three residential units.*
- 22) Standard 504-4 C specifies that parking be located to the side or rear of the building and that the parking be screened from the public way. *The parking for 143 Village Street is located within the building and along the Sanford Street side of the building. Landscaping will be provided along the property’s eastern boundary and a fence will be installed along the western and southern boundaries to provide screening.*
- 23) Standard 504-C indicates that parking areas shall include provisions for current or future shared and/or linked parking with adjacent properties when such linking can be accomplished without significant degradation of the character of the neighborhood. *The owner of the adjacent property at 151 Village Street and 4 Sanford Street is not receptive to providing access to link parking areas on the respective properties. Furthermore, linked parking is more appropriate for commercial properties.*
- 24) Standard 504-D specifies that lighting shall be of residential scale, architecturally compatible with the building, and shall be designed to ensure that no glare is produced on abutting properties or the public way. *The proposed lighting is appropriate for the residential use. The selection of lighting fixtures and light levels have been revised so as to not produce glare on abutting properties or the public way.*
- 25) Standard 504-E prohibits new curb cuts and expansion of existing curb unless the PEDB finds that such changes are necessary to ensure safe access. *The existing curb cut on Sanford Street is being adjusted and reduced in width to 30 feet to improve safety and sight lines.*
- 26) Standard 504-F provides that significant pedestrian and bicycle access (including bicycle parking) shall be provided. *There is an existing sidewalk on Village and*

*Sanford Streets so both pedestrians and cyclists will be able to access the site. However, there is no provision for the installation of a bicycle rack on the premises. The applicant has requested a waiver from the requirement to install a bicycle rack on the premises. See **Waiver # _____** of this decision. As this development is 100% residential, there is no need to provide for bicycle parking for consumers as would be the case with a commercial development. Storage of personal bicycles for residents/guests can be readily accomplished in the garage parking available for each unit.*

- 27) Standard 504-G specifies that a landscape plan is provided to maintain or enhance the residential character of the property and to provide screening for parking, loading and refuse storage facilities. *A landscaping plan is included in the plan set.*
- 28) Standard 504-I provides that at least two off-street parking spaces shall be provided for every residential unit in a building with one (1) or more residences. *The site plan for 143 Village Street shows a total of 6 on-site parking spaces. This meets the minimum required for 3 units.*

GROUNDWATER PROTECTION DISTRICT SPECIAL PERMIT FINDINGS

- 29) The area of the parcel within the Groundwater Protection District is 5,456.6 sq. ft. This comprises 93% of the site.
- 30) Post construction impervious coverage = 3,719 sq. ft. This comprises 63% of the site.
- 31) The proposed residential use is not prohibited by Section 5.6.3 of the *Zoning Bylaw*. New residential construction is a permitted use, subject to certain restrictions, within the Groundwater Protection District. As conditioned and noted below, the project will comply with those restrictions.
- 32) Storage of hazardous materials is prohibited unless in a free-standing container within a building. Storage of hazardous materials is not anticipated. In any case, as a precautionary measure, any hazardous materials that will be used at the facility will be identified and a list provided to the Board (**See Condition _____ herein**). All storage and use of hazardous materials will be contained within the building. Any accidental spillage will also be contained within the building and any that enters the sewer system will be treated prior to being discharged to the municipal sewer system.
- 33) Fertilizers may be used on landscape material but will be the minimum necessary (**See Condition _____ herein**). All storage will be contained within the building.
- 34) Any use of hazardous materials will occur within the building.
- 35) There will be no earth removal within six feet of the historical high groundwater level except for construction of the open stormwater basin that is receiving required pre-treatment as reviewed by the Town's Consulting Engineer.

- 36) Water control devices are prohibited unless they can be shown to prevent adverse impacts on groundwater. The stormwater management plans have been reviewed by the Town's Consulting Engineer to ensure that no adverse impacts will result.
- 37) The Town's Consulting Engineer has reviewed the planned stormwater management facilities to ensure that groundwater recharge does not degrade groundwater quality.
- 38) As required by Section 5.6.F. of the Zoning Bylaw, the plans were distributed to the Board of Health, Conservation Commission, Water and Sewer Commission, and Department of Public Services for review and comment to ensure that no adverse impacts on the quality or quantity of water available within the Groundwater Protection District, and that disturbance of the soils, topography, drainage, vegetation and other characteristics is minimized. Due to the planned stormwater management facilities, the proposed facility will reduce impacts on the quality of water available within the Groundwater Protection District.

VII. WAIVERS – At its October 30, 2017 meeting, the Planning and Economic Development Board, on a motion made by _____ and seconded by _____ Thomas Gay, voted to _____ waivers from the following provisions of the *Rules and Regulations for the Submission and Approval of Site Plans, as amended December 3, 2002, and the Adaptive Use Overlay District Rules and Regulations*. The Planning and Economic Development Board's action and reasons for granting each waiver request are listed below. All waivers are subject to the *Special and General Conditions of Approval*, which follow this section. The motion was approved unanimously by a vote of five in favor and zero opposed.

SITE PLAN RULES AND REGULATIONS

- 1) **Section 204-3 A. 7. Development Impact Statement Section** - The applicant shall submit a written *Development Impact Statement* which shall describe the potential and anticipated impacts of the proposed development, identify all positive and adverse impacts, and propose an acceptable program to prevent or mitigate adverse impacts.

At its discretion, the Planning Board, upon written request of the applicant, and based on the Board's preliminary assessment of the scale and type of development proposed, may waive or modify the requirements for submission of any of the elements of the *Development Impact Statement*.

The *Development Impact Statement* shall consist of the following four elements – traffic, environmental, community and parking.

The Applicant has requested a full waiver from this requirement. The scale of the project is minimal and it is costly to prepare an impact report. The Town's Consulting Engineer has no objection to this alternative. Therefore, the Board APPROVES this waiver request.

- 2) **Section 204-4 Standards for Site Plan Preparation, B. Plan Scale** - The site plan shall be drawn at a scale of one (1) inch equals forty (40) feet or such other scale that has been approved in advance by the Planning Board and that clearly and adequately represents the proposed improvements.

The Applicant has requested a waiver from this requirement and used a 1" = 10' scale in lieu of the standard 1" = 40' scale. As the site is relatively small, this scale provides for a clearer and neater plan than can show more detail than a comparable plan at 1" = 40'. The Town's Consulting Engineer has no objection to this alternative. Therefore, the Board APPROVES this waiver request.

- 3) **Section 204-5 C. 3. Existing Landscape Inventory** - An *Existing Landscape Inventory* shall be prepared by a Professional Landscape Architect licensed in the Commonwealth of Massachusetts. This inventory shall include a "mapped" overview of existing landscape features and structures and a general inventory of major plant species including the specific identification of existing trees with a diameter of one (1) foot or greater at four (4) feet above grade.

Section 204-5 D7 – Landscape Architectural Plan –A *Landscape Architectural Plan* shall be prepared by a Landscape Architect licensed in the Commonwealth of Massachusetts. This *Plan* shall be prepared as an overlay of the existing conditions sheets and shall incorporate, whenever possible, the significant features of the existing site and topography, particularly existing trees with a diameter of one (1) foot or greater at four (4) feet above grade. The *Landscape Architectural Plan* shall indicate the areas slated for excavation; any woodlands, trees or other existing features or structures to be retained; all new plantings by common and Latin name including their proposed locations and sizes at the time of installation. Plan graphics for tree canopies shall reflect, as closely as possible, the actual canopy dimension of proposed tree plantings at the time of installation with a "lesser" intensity graphic used to represent potential canopy at maturity.

The Applicant has requested waivers from these requirements. There are minimal landscape features on the site. As the site is so small and the project scale is modest, there is no added value in preparing an inventory of the existing landscape given the site's existing conditions. The Applicant proposes to have an experienced site designer prepare the landscape plan in lieu of a licensed landscape architect. Therefore, the Board APPROVES this waiver request.

- 4) **Section 205-3 Traffic. A. Curb Cuts. 6) Driveway Distance from Intersection** - Where a site occupies a corner of two (2) intersecting roads, the curb cut shall be as remote from the intersection as possible. No curb cut shall be located within fifty (50) feet of the point of tangency of the existing or proposed curb radius of that site.

The Applicant has requested a waiver from this requirement. The proposed entrance to the site from Sanford Street is ___ feet south of the intersection of Village and Sanford Streets. The applicant has reduced the size of the driveway from its existing width of ___ down to ___ feet, thus increasing the distance from the intersection as far as is practical given the property boundaries and site access requirements. Furthermore, the curb radius at the intersection has been reduced to help slow down vehicles turning southbound onto Sanford Street from Village Street and improve sight distance in order to help mitigate the proximity of the curb cut to the intersection. Therefore, the Board _____ this waiver request.

ADAPTIVE USE DISTRICT SITE DEVELOPMENT STANDARDS

- 5) **Section 504-4 F.** - Significant pedestrian and bicycle access (including bicycle parking) shall be provided.

The applicant has requested a waiver from the bicycle parking portion of this regulation. Secure bicycle parking will be available in the lower level entry area and garage of each dwelling unit for residents. Bicycle parking for customers is not needed as the development is 100% residential. Therefore, the Board APPROVES this waiver.

- VIII. CONDITIONS** - The *Special and General Conditions* included in this Decision shall assure that the Board's approval of this site plan complies with the *Medway Zoning Bylaw*, Section 5.6.4, is consistent with *Site Plan Rules and Regulations*, that the comments of various Town boards and public officials have been adequately addressed, and that concerns of abutters and other community residents which were aired during the public hearing process have been carefully considered

SPECIFIC CONDITIONS OF APPROVAL

- A. Notwithstanding any future amendment of the *Medway Zoning Bylaw*, G.L. c.40A, or any other legislative act:
1. The maximum number of dwelling units to be constructed under this special permit shall be three.
 2. The tract(s) of land on which this ARCPUD is to be located shall not be altered or used except:
 - a) as granted by this special permit;
 - b) substantially as shown on the plan entitled 143 Village Street dated September 6, 2017, last revised October 10, 2017 to be further revised as referenced herein; and
 - c) in accordance with subsequent approved plans or amendments to this special permit.
 3. The tract of land and building shall not be used, sold, transferred or leased except in conformity with this special permit and shall not be further divided.
- B. **Plan Endorsement** - Within sixty (60) days after the Board has filed its *Decision* with the Town Clerk, the site plan set for 143 Village Street, dated September 6, 2017, last revised October 10, 2017, prepared by Guerriere & Halnon, Inc. of Franklin, MA and building elevations by JG Architects of Holliston, MA, shall be further revised to reflect all Conditions and required revisions, including those as follows, and shall be submitted to the Planning and Economic Development Board to review for compliance with the Board's *Decision*. (*Said plan is hereinafter referred to as the Plan*). Upon approval, the Applicant shall provide a Mylar of the revised Plan set in its final form to the Board for its

signature/endorsement prior to recording at the Norfolk County Registry of Deeds along with this decision. All Plan sheets shall be bound together in a complete set.

- C. **Cover Sheet Revisions** – Prior to plan endorsement, the Cover Sheet of the October 10, 2017 site plan shall be revised as follows:
1. Revised plan date shall be prominently displayed.
 2. Include the list of APPROVED Requests for Waivers
 3. Revise the Index List to include the architectural drawings by JG Architects.
 4. Add a Town Clerk's signature area for verification that the 20 day appeal period has expired.
 5. Add a note referencing this special permit and that it will be recorded with the plan at the Norfolk County Registry of Deeds
 6. Revise item #5 under Notes to indicate that the referenced "Board" is the Zoning Board of Appeals.
- D. **Other Plan Revisions** – Prior to plan endorsement, the following plan revisions shall be made to the October 10, 2017 site plan.
1. A separator row shall be incorporated into the Cultec system.
 2. Adjust the lighting design such that there is no light spillage onto adjacent property from the site.
 3. Include the signature block for the Planning and Economic Development's Board's signature on all plan sheets.
 4. Revise and reduce the turning radius of the southwest corner of Sanford and Village Streets
 5. Relocate sidewalk away from private property and into the right of way. Denote who is responsible for sidewalk construction. Sidewalk construction shall be ADA/AAB compliant.
 7. Changes to the exterior appearance of the building per the recommendations of the Design Review Committee as follows:
 - a. Install or paint the shutters black
 - b. Paint the garage doors a contrasting color and/or provide a decorative trim or architecture feature that would provide some color contrast between the colors of the garage doors and the siding.
 - c. The block retaining wall shall be constructed using the Sandlewood color for the SEMMA style wall and the architectural style cap by Techo Bloc (or equivalent).
 - d. Install fencing along the western and southern elevations of the site having a naturalized wood look with a non-white, matte finish. Use Scallop Hamilton fence by Colonial Fencing with a Dado Capstrip with 1" spacing (or equivalent)
 8. Show the installation of a "No Parking Here to Corner" sign on Sanford Street south of the driveway at the lot line. (Per the recommendation of the Medway Police Department.)
 9. Add a note that site grading and landscaping within 10 feet of Sanford Street shall be completed to be as low as possible so as to accomplish the best possible sight lines for vehicles exiting from the property. (Per the recommendation of the Medway Police Department.)

10. Include a specification that the underground stormwater structures shall include a separator.
- E. **Open Space/Yard Area** - At least 15% of the site shall be retained as open space and/or yard area in perpetuity. This area shall be unpaved but may be landscaped or left natural, with the balance being trees, shrubs and grass suitable for the site. This area shall not be built upon but may include a play area.
- F. **Sidewalk Construction** – The sidewalk reconstruction along the west side of Sanford Street shall be completed to the Town’s satisfaction before the occupancy permit is issued for the first condominium unit.
- G. **Architectural and Site Design Details**
 1. Before construction commences, the Applicant shall meet with the Design Review Committee with product samples to finalize plans for:
 - a. lighting fixtures for front entrance, rear walkway and stairs and recessed down lights above the garage doors
 - b. landscaping and/or fencing to screen the mechanical equipment located at the southwest corner of the property
 - c. conversion of 3 small round windows to larger openings or awning style windows
 - d. retaining wall, fencing, and stone wall work
 - e. painting the brick on the building’s north elevation where it appears a basement window was removed or reinstalling a window back in this location.
 2. Construction or reconstruction of stone walls on the Sanford Street frontage shall be completed in manner where the appearance is reminiscent of or compatible with the existing stone walls on the premises.
- H. The Declaration of Trust for the 143 Village Street Condominium shall include the following language: *“The construction and operation of the condominium is authorized by a Multifamily Housing Special Permit, Groundwater Protection District Special Permit and Site Plan Approval granted by the Medway Planning and Economic Development Board on October 30, 2017, a copy of which is available for inspection at the Town Clerk’s office and which is recorded at the Norfolk County Registry of Deeds.*
- I. **Water Conservation** – The development is relying on the Town’s public water system and the Town is being held to its Water Management Act Permit with the Mass Department of Environmental Protection. The Applicant shall incorporate the following water conservation measures for construction of the development: well water for landscape irrigation, rain-gauge controlled irrigation systems, low flow household fixtures, and conservation rated appliances.
- J. **Addresses** –The addresses for the condominium units shall be 143 Village Street, Units 1, 2 and 3 or as otherwise determined by the Medway Assessor upon consultation with the Fire and Police Chiefs.
- K. **Development Signage** – Any future development signage for this project shall comply with the sign regulations of the Medway *Zoning Bylaw*.

L. *Drainage/Stormwater Management*

1. Prior to plan endorsement, the Applicant shall provide a memo summarizing how the stormwater design complies with each of the 10 Massachusetts stormwater standards to the Board for its review and approval.
2. Prior to plan endorsement, the Applicant shall provide a long term stormwater operations and maintenance plan to the Board for its review and approval.
3. Until transferred to the 143 Village Street Condominium Trust, the Applicant shall be responsible for keeping the constructed stormwater drainage system in a clean and well-functioning condition, and shall do nothing which would alter the drainage patterns or characteristics as indicated on the Plan approved herein without the express written approval of the Planning and Economic Development Board.
4. The stormwater drainage system shall be maintained by the applicant and its successors and assigns and shall not be dedicated to the Town. It is the intent of the Planning and Economic Development Board and the applicant that this stormwater system not be accepted by Town Meeting.
5. The applicant and its successors and assigns (future condominium owners) shall maintain the stormwater management system in accordance with the operation and maintenance plan.
6. In the event a management company is engaged by the condominium association, the stormwater maintenance and operation plan shall be incorporated by reference in the management contract.
7. In the event that the Applicant, its successors, or agent fails to maintain the stormwater management system in accordance with the applicable guidelines for operation and maintenance, the Town may conduct such maintenance or repairs as the Town determines in its sole discretion are reasonably necessary, and the Applicant hereby consents to allow the town and its agents, employees and contractors entry onto the Property to implement the measures set forth in such guidelines. In the event the Town conducts such maintenance or repairs, the Applicant shall promptly reimburse the Town for all reasonable expenses associated therewith; if the applicant fails to so reimburse the Town, the Town may place a lien on the site or any unit therein to secure such payment.

M. *Parking*

1. Residents and guests shall exit the premises facing out to Sanford Street. The backing out of vehicles onto Sanford Street shall be violation of this decision/permit.
2. Parking or use of the parking area at 143 Village Street shall be limited only to vehicles for residents and their guests. The parking area may not be leased or made available to any other business for any purpose.

N. Groundwater Protection

1. Storage of hazardous materials is prohibited unless in a free-standing container within a building. Any hazardous materials that will be used on the premises shall be identified and a list provided to the Board. All use of hazardous materials shall be contained within the building. Any accidental spillage shall also be contained within the building and any that enters the sewer system shall be treated prior to being discharged to the municipal sewer system.
2. Any fertilizers used on landscape material anywhere on the site shall be the slow-release organic granular type, and only the absolute minimum necessary. All storage of fertilizers shall be contained within the building.
3. Outdoor storage anywhere on the site shall consist only of non-hazardous materials. Metal materials stored outside shall be under cover of a building or structure to prevent leaching of the metal into the groundwater.
4. There shall be no use of pesticides, herbicides, fungicides or insecticides anywhere on the exterior of the site.
5. Deicing materials shall be limited to calcium chloride or other deicer material approved by the Medway Department of Public Services.
6. Plowed snow for the site shall be stored only in the designated areas shown on the plan or taken off site in times of substantial storms.
7. The stormwater management facilities shall be maintained in accordance with the stormwater operations and maintenance plan.
8. All vehicles shall be parked/stored on the paved surface to ensure treatment of any leaks of fluids from the vehicles. There shall be no outdoor maintenance or cleaning of vehicles.
9. The Town reserves the right to periodically inspect the site to ensure compliance with these conditions.
10. Any future changes to roofing materials shall be reviewed by the Board and may necessitate an amendment to the Groundwater Protection District Special Permit to ensure that roofing materials do not result in negative impacts to the groundwater supply.

O. Recording of Plans and Documents

1. The Plan of Record associated with this special permit is: *Multi Family Housing Special Permit 143 Village Street*, last revised October 10, 2017 to be further revised as specified herein, prepared by Dale MacKinnon, P.E. of Guerriere and Halnon of Franklin, MA. with architectural drawings by JG Architects of Holliston, MA.
2. No construction shall begin on the site and no building permit shall be issued before the following documents/plans are recorded at the Norfolk County Registry of Deeds:
 - a) This special permit decision

- b) The Plan of Record endorsed by the Planning and Economic Development Board
- 3. The following documents, which shall be in compliance with the conditions of this decision, shall be recorded at the Norfolk County Registry of Deeds prior to the issuance of an occupancy permit for the first dwelling unit.
 - a) 143 Village Street Condominium Master Deed
 - b) Declaration of Trust of 143 Village Street Condominium Trust
- 4. Within thirty days of recording, the Applicant or his assign shall provide the Planning and Economic Development Board with a receipt from the Norfolk County Registry of Deeds indicating that all documents have been duly recorded, or supply another alternative verification that such recording has occurred.

GENERAL CONDITIONS OF APPROVAL

- A. **Fees** - Prior to plan endorsement by the Planning and Economic Development Board, the Applicant shall pay:
 - 1. the balance of any outstanding plan review fees owed to the Town for review of the site plan by the Town's engineering, planning or other consultants; and
 - 2. any construction inspection fee that may be required by the Planning and Economic Development Board; and
 - 3. any other outstanding expenses or obligations due the Town of Medway pertaining to this property, including real estate and personal property taxes and business licenses.

The Applicant's failure to pay these fees in their entirety shall be reason for the Planning and Economic Development Board to withhold plan endorsement.

- B. **Other Permits** – This permit does not relieve the applicant from its responsibility to obtain, pay and comply with all other required federal, state and Town permits. The contractor for the applicant or assigns shall obtain, pay and comply with all other required Town permits.
- C. **Restrictions on Construction Activities** – During construction, all local, state and federal laws shall be followed regarding noise, vibration, dust and blocking of town roads. The applicant and its contractors shall at all times use all reasonable means to minimize inconvenience to abutters and residents in the general area. The following specific restrictions on construction activity shall apply.
 - 1. **Construction Time** - Construction work at the site and in the building and the operation of construction equipment including truck/vehicular and machine start-up and movement shall commence no earlier than 7 a.m. and shall cease no later than 6 p.m. Monday – Saturday. No construction shall take place on Sundays or legal holidays without the advance approval of the Inspector of Buildings.

2. The applicant shall take all measures necessary to ensure that no excessive dust leaves the premises during construction including use of water spray to wet down dusty surfaces.
3. There shall be no tracking of construction materials onto any public way. Daily sweeping of roadways adjacent to the site shall be done to ensure that any loose gravel/dirt is removed from the roadways and does not create hazardous or deleterious conditions for vehicles, pedestrians or abutting residents. In the event construction debris is carried onto a public way, the Applicant shall be responsible for all clean-up of the roadway which shall occur as soon as possible and in any event within twelve (12) hours of its occurrence.
4. The Applicant is responsible for having the contractor clean-up the construction site and the adjacent properties onto which construction debris may fall on a daily basis.
5. All erosion and siltation control measures shall be installed by the Applicant prior to the start of construction and observed by the Planning and Economic Development Board's consulting engineer and maintained in good repair throughout the construction period.
6. *Construction Traffic/Parking* – During construction, adequate provisions shall be made on-site for the parking, storing, and stacking of construction materials and vehicles. All parking for construction vehicles and construction related traffic shall be maintained on site. No parking of construction and construction related vehicles shall take place on adjacent public or private ways or interfere with the safe movement of persons and vehicles on adjacent properties or roadways.
7. *Noise* - Construction noise shall not exceed the noise standards as specified in the *Medway General Bylaws* and the *Medway Zoning Bylaw*, SECTION V. USE REGULATIONS, Sub-Section B. Area Standards, Paragraph 2. b). as may be amended.

D. ***Landscape Maintenance***

1. The site's landscaping shall be maintained in good condition throughout the life of the facility and to the same extent as shown on the endorsed Plan. Any shrubs, trees, bushes or other landscaping features shown on the Plan that die shall be replaced by the following spring.
2. Within 60 days after two years after the last occupancy permit is issued, the Town's Consulting Engineer or the Inspector of Buildings shall conduct an initial inspection of the landscaping to determine whether and which landscape items need replacement or removal and provide a report to the Board. At any time subsequent to this initial inspection, the Town's Consulting Engineer or the Inspector of Buildings may conduct further inspections of the landscaping to determine whether and which landscaping items need replacement or removal and provide a report to the Board. The Board may seek enforcement remedies with the Inspector of

Buildings/Zoning Enforcement Officer to ensure that the comprehensive landscaping plan is maintained.

E. ***Snow Storage and Removal***

1. On-site snow storage shall not encroach upon nor prohibit the use of any parking spaces required by the *Zoning Bylaw*.
2. Accumulated snow which exceeds the capacity of the designated on-site snow storage areas shall be removed from the premises within 24 hours after the conclusion of the storm event.

F. ***Right to Enter Property*** – Duly authorized agent(s) of the Town of Medway shall have the right to enter upon the common areas of the condominium to ensure continued compliance with the terms and conditions of this special permit.

G ***Construction Oversight***

1. Construction Account
 - a) Inspection of infrastructure and utility construction, installation of site amenities including landscaping, and the review of legal documents by Town Counsel is required. Prior to plan endorsement, the applicant shall establish a construction account with the Planning and Economic Development Board. The funds may be used at the Board's discretion to retain professional outside consultants to perform the items listed above as well as the following other tasks - inspect the site during construction/installation, identify what site plan work remains to be completed, prepare a bond estimate, conduct other reasonable inspections until the site work is completed and determined to be satisfactory, review as-built plans, and advise the Board as it prepares to issue a *Certificate of Site Plan Completion*).
 - b) Prior to plan endorsement, the Applicant shall pay an advance toward the cost of these services to the Town of Medway. The advance amount shall be determined by the Planning and Economic Development Board based on an estimate provided by the Town's Consulting Engineer.
 - c) Depending on the scope of professional outside consultant assistance that the Board may need, the Applicant shall provide supplemental payments to the project's construction inspection account, upon invoice from the Board.
 - d) Any funds remaining in the applicant's construction inspection account after the *Certificate of Site Plan Completion* is issued shall be returned to the applicant.
2. Planning and Economic Development Board members, its staff, consultants or other designated Town agents and staff shall have the right to inspect the site at any time, for compliance with the endorsed site plan and the provisions of this Decision.

3. The Department of Public Services will conduct inspections for any construction work occurring in the Town's right-of way in conjunction with the Town of Medway Street Opening/Roadway Access Permit.
4. The applicant shall have a professional engineer licensed in the Commonwealth of Massachusetts conduct progress inspections of the construction of the approved site improvements. Inspections shall occur at least on a monthly basis. The engineer shall prepare a written report of each inspection and provide a copy to the Planning and Economic Development Board within 5 days of inspection.

H. ***Plan Modification***

1. This Site Plan Approval is subject to all subsequent conditions that may be imposed by other Town departments, boards, agencies or commissions. Any changes to the site plan that may be required by the decisions of other Town boards, agencies or commissions shall be submitted to the Planning and Economic Development Board for review as site plan modifications.
2. Any work that deviates from an approved site plan shall be a violation of the *Medway Zoning Bylaw*, unless the Applicant requests approval of a plan modification pursuant to Section 3.5.2.A.3.c. and such approval is provided in writing by the Planning and Economic Development Board.
3. Whenever additional reviews by the Planning and Economic Development Board, its staff or consultants are necessary due to proposed site plan modifications, the Applicant shall be billed and be responsible for all supplemental costs including filing fees, plan review fees and all costs associated with another public hearing including legal notice and abutter notification. If the proposed revisions affect only specific limited aspects of the site, the Planning and Economic Development Board may reduce the scope of the required review and waive part of the filing and review fees.

I. ***Plan Compliance***

1. The Applicant shall construct all improvements in compliance with the approved and endorsed site plan and any modifications thereto.
2. The Planning and Economic Development Board or its agent(s) shall use all legal options available to it, including referring any violation to the Building Commissioner/Zoning Enforcement Officer for appropriate enforcement action, to ensure compliance with the foregoing Conditions of Approval.
3. The Conditions of Approval are enforceable under Section 3.1. F. of the *Medway Zoning Bylaw* (non-criminal disposition) and violations or non-compliance are subject to the appropriate fine.

J. ***Performance Security***

1. No occupancy permit shall be granted until the Planning and Economic Development Board has provided a written communication to the Inspector of Buildings/Zoning Enforcement Officer that the project, as constructed, conforms completely and fully to the approved site plan and

that any conditions including construction of any required on and off-site improvements, have been satisfactorily completed OR that suitable security/performance guarantee has been provided to the Town of Medway, to the Planning and Economic Development Board's satisfaction, to cover the cost of all remaining work.

2. The applicant shall propose a form of performance security which shall be of a source and in a form acceptable to the Planning and Economic Development Board, the Treasurer/Collector and Town Counsel. The Board may require that the performance guarantee be accompanied by an agreement which shall define the obligations of the developer and the performance guarantee company including:
 - a) the date by which the developer shall complete construction
 - b) a statement that the agreement does not expire until released in full by the Planning and Economic Development Board
 - c) procedures for collection upon default.
3. The amount of the performance guarantee shall be equal to 100% of the amount that would be required for the Town of Medway to complete construction of the site infrastructure including installation of stormwater management facilities, utilities, services, pedestrian facilities and all site amenities and all mitigation measures as specified in the Plan that remain unfinished at the time the performance guarantee estimate is prepared if the developer failed to do so.
4. The security amount shall be approved by the Planning and Economic Development Board based on an estimate provided by the Town's Consulting Engineer based on the latest weighted average bid prices issued by the Mass Highway Department. The estimate shall reflect the cost for the Town to complete the work as a public works project which may necessitate additional engineering, inspection, legal and administrative services, staff time and public bidding procedures. The estimate shall also include the cost to maintain the infrastructure in the event the developer fails to adequately perform such and the cost for the development of as-built plans. In determining the amount, the Board shall be guided by the following formula in setting the sum: estimate of the Town's Consulting Engineer of the cost to complete the work plus a twenty-five percent (25%) contingency.
5. Final release of performance security is contingent on project completion.

K. Project Completion

1. Site plan approval shall lapse after one (1) year of the grant thereof if substantial use has not commenced except for good cause. The approved site plan shall be completed by the applicant or its assignees within two (2) years of the date of plan endorsement. Upon receipt of a written request by the applicant filed at least thirty (30) days prior to the date of expiration, the Planning and Economic Development Board may grant an extension for good cause. The request shall state the reasons for the extension and also the length of time requested. If no request for extension

is filed and approved, the site plan approval shall lapse and may be reestablished only after a new filing, hearing and decision.

2. Prior to issuance of the occupancy permit for the eighth dwelling unit, the Applicant shall secure a ***Certificate of Site Plan Completion*** from the Planning and Economic Development Board and provide the ***Certificate*** to the Inspector of Buildings. The ***Certificate*** serves as the Planning and Economic Development Board's confirmation that the completed work conforms to the approved site plan and any conditions and modifications thereto, including the construction of any required on and off-site improvements. The ***Certificate*** also serves to release any security/performance guarantee that has been provided to the Town of Medway. To secure a ***Certificate*** of Site Plan Completion, the applicant shall:

- a) provide the Planning and Economic Development Board with written certification from a Professional Engineer registered in the Commonwealth of Massachusetts that all building and site work has been completed in strict compliance with the approved and endorsed site plan, and any modifications thereto; and
- b) submit an electronic version of an As-Built Plan, prepared by a registered Professional Land Surveyor or Engineer registered in the Commonwealth of Massachusetts, to the Planning and Economic Development Board for its review and approval. The As-Built Plan shall show actual as-built locations and conditions of all buildings and site work shown on the original site plan and any modifications thereto. The final As-Built Plan shall also be provided to the Town in CAD/GIS file format per MASS GIS specifications.

L. ***Construction Standards*** - All construction shall be completed in full compliance with all applicable local, state and federal laws, including but not limited to the Americans with Disabilities Act and the regulations of the Massachusetts Architectural Access Board for handicap accessibility.

M. ***Conflicts*** – If there is a conflict between the site plan and the Decision's Conditions of Approval, the Decision shall rule. If there is a conflict between this Decision and/or site plan and the Medway *Zoning Bylaw*, the Bylaw shall apply.

IX. APPEAL – Appeals if any, from this Decision shall be made to the court within twenty (20) days of the date the Decision is filed with the Town Clerk.

After the appeal period has expired, the applicant must obtain a certified notice from the Town Clerk that no appeals have been made and provide such certification to the Planning and Economic Development Board before plan endorsement.

###

**Medway Planning and Economic Development Board
SITE PLAN and SPECIAL PERMIT DECISION
143 Village Street**

_____ by the Medway Planning & Economic Development Board: _____

AYE:

NAY:

ATTEST:

Susan E. Affleck-Childs
Planning & Economic Development Coordinator

Date

COPIES TO: Michael Boynton, Town Administrator
David D'Amico, Department of Public Services
Bridget Graziano, Conservation Agent
Donna Greenwood, Assessor
Beth Hallal, Health Agent
Jeff Lynch, Fire Chief
Jack Mee, Inspector of Buildings and Zoning Enforcement Officer
Stephanie Mercandetti, Director of Community and Economic Development
Joanne Russo, Treasurer/Collector
Jeff Watson, Police Department
N.E. Premier Properties, LLC
Dale MacKinnon, Guerriere & Halnon
Danell Baptiste, Guerriere & Halnon
Steven Bouley, Tetra Tech
Gino Carlucci, PGC Associates



October 30, 2017
Medway Planning & Economic Development Board
Meeting

Construction Services Estimates

- 10/26/17 Tetra Tech estimate for Country Cottage Children's Center
- 10/26/17 Tetra Tech estimate for 143 Village Street Condominium



**Country Cottage Children's Center
Construction Administration Budget
October 26, 2017**

Item No. ¹	Inspection	Site Visits	Hrs/Inspection ²	Rate	Total
1	Erosion Control/SWPPP Inspections	4	1	\$95	\$380
2	Clearing & Grubbing/Demolition	1	3	\$95	\$285
3	Subgrade/Staking	1	3	\$95	\$285
4	Drainage: Sub. Infil. Basin/Rain Garden	2	3	\$140	\$840
5	Drainage: Piped Infrastructure	1	3	\$95	\$285
6	Sewer Service	1	3	\$95	\$285
7	Water Service/Hydrant Relocation	1	3	\$95	\$285
8	Private Utilities	1	3	\$95	\$285
9	Site Rough Grading	1	3	\$95	\$285
10	Site Subbase Gravel/Fine Grading	1	3	\$95	\$285
11	Binder Course Paving	1	4	\$95	\$380
12	Curb/Berm	1	3	\$95	\$285
13	Top Course Paving	1	4	\$95	\$380
14	Landscape/Plantings	1	3	\$95	\$285
15	Long Term Stormwater Inspections	4	2	\$95	\$760
16	Bond Estimates	1	6	\$140	\$840
17	Punch List Inspections ³	2	4	\$140	\$1,120
18	As-Built Review ⁴	2	4	\$140	\$1,120
19	Meetings	4	1	\$140	\$560
20	Admin	3	1	\$63	\$189
	Subtotal				\$9,419
	Expenses			5.0%	\$471
	TOTAL				\$9,890

Notes:

¹ Each item includes site visit, inspection and written report. If construction extends beyond June 30, 2018, this estimate will be revised to utilize updated TT/Town of Medway contract hourly rates.

² If installation schedule is longer than that assumed by engineer for any item above, or if additional inspections are required due to issues with the contract work, additional compensation may be required.

³ Punch List Inspections include a substantial completion inspection and Punch List memo provided to the town. It also includes one final inspection to verify that comments from the list have been addressed and one revision to the list if required.

⁴ This item includes review of As-Built Plans, review letter and coordination with the applicant to address any issues on the plans.

Date Approved by Medway Planning and Economic Development Board _____

Certified by: _____

Susan E. Affleck-Childs

Date

Medway Planning and Economic Development Coordinator



143 Village Street
Construction Administration
Budget October 26, 2017

Item No. ¹	Inspection	Site Visits	Hrs/Inspection ²	Rate	Total
1	Erosion Control/SWPPP Inspections	4	1	\$95	\$380
2	Clearing & Grubbing/Demolition	1	3	\$95	\$285
3	Subgrade/Staking	1	3	\$95	\$285
4	Drainage: Sub. Infil. Basin	1	3	\$140	\$420
5	Drainage: Piped Infrastructure	1	3	\$95	\$285
6	Sewer Service	1	3	\$95	\$285
7	Water Service	1	3	\$95	\$285
8	Private Utilities	1	3	\$95	\$285
9	Site Rough Grading	1	3	\$95	\$285
10	Site Subbase Gravel/Fine Grading	1	3	\$95	\$285
11	Binder Course Paving	1	4	\$95	\$380
12	Curb/Berm	1	3	\$95	\$285
13	Top Course Paving	1	4	\$95	\$380
14	Landscape/Plantings	1	3	\$95	\$285
15	Long Term Stormwater Inspections	4	1	\$95	\$380
16	Bond Estimates	1	4	\$140	\$560
17	Punch List Inspections ³	2	4	\$140	\$1,120
18	As-Built Review ⁴	2	4	\$140	\$1,120
19	Meetings	4	1	\$140	\$560
20	Admin	3	1	\$63	\$189
	Subtotal				\$8,339
	Expenses			5.0%	\$417
	TOTAL				\$8,756

Notes:

¹ Each item includes site visit, inspection and written report. If construction extends beyond June 30, 2018, this estimate will be revised to utilize updated TT/Town of Medway contract hourly rates.

² If installation schedule is longer than that assumed by engineer for any item above, or if additional inspections are required due to issues with the contract work, additional compensation may be required.

³ Punch List Inspections include a substantial completion inspection and Punch List memo provided to the town. It also includes one final inspection to verify that comments from the list have been addressed and one revision to the list if required.

⁴ This item includes review of As-Built Plans, review letter and coordination with the applicant to address any issues on the plans.

Date Approved by Medway Planning and Economic Development Board _____

Certified by: _____

Susan E. Affleck-Childs

Date

Medway Planning and Economic Development Coordinator