

Deck Section

NOTE: WHERE SUPPORTED BY ATTACHMENT TO AN EXTERIOR WALL, DECKS SHALL BE POSITIVELY ANCHORED TO THE PRIMARY STRUCTURE AND DESIGNED FOR BOTH VERTICAL AND LATERAL LOADS AS APPLICABLE. SUCH ATTACHMENT SHALL NOT BE ACCOMPLISHED BY THE USE OF TOENAILS OR NAILS SUBJECT TO WITHDRAWAL. WHERE POSITIVE CONNECTION TO THE PRIMARY STRUCTURE CANNOT BE VERIFIED DURING INSPECTION, DECKS SHALL BE SELF-SUPPORTING. (R502.2.2)

NOTE:
GUARDS ARE REQ. FOR
DECKS W/ SURFACES
LOCATED MORE THAN 30"
ABOVE THE GRADE BELOW.
(R312.1)

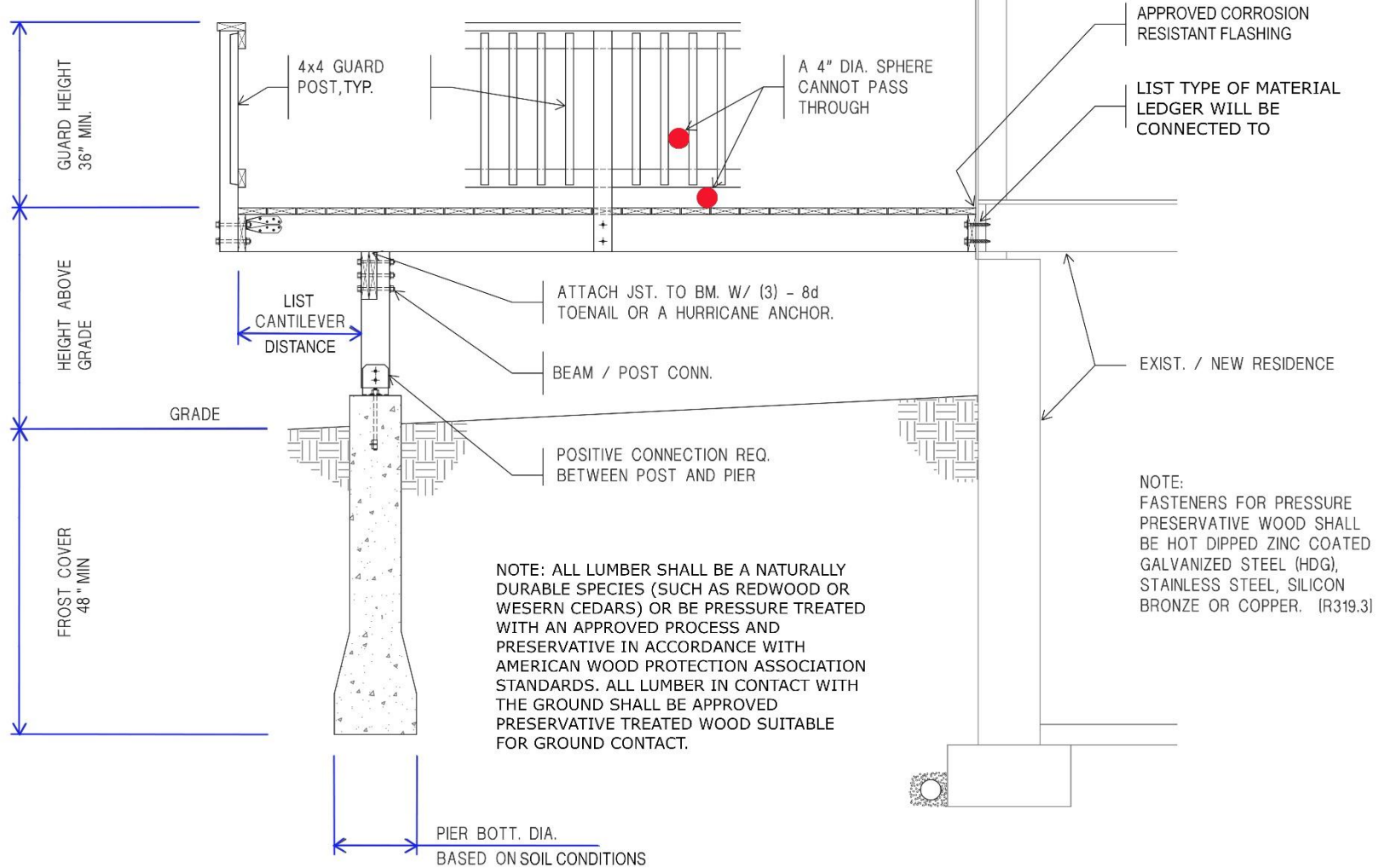

Typical Deck Framing Plan

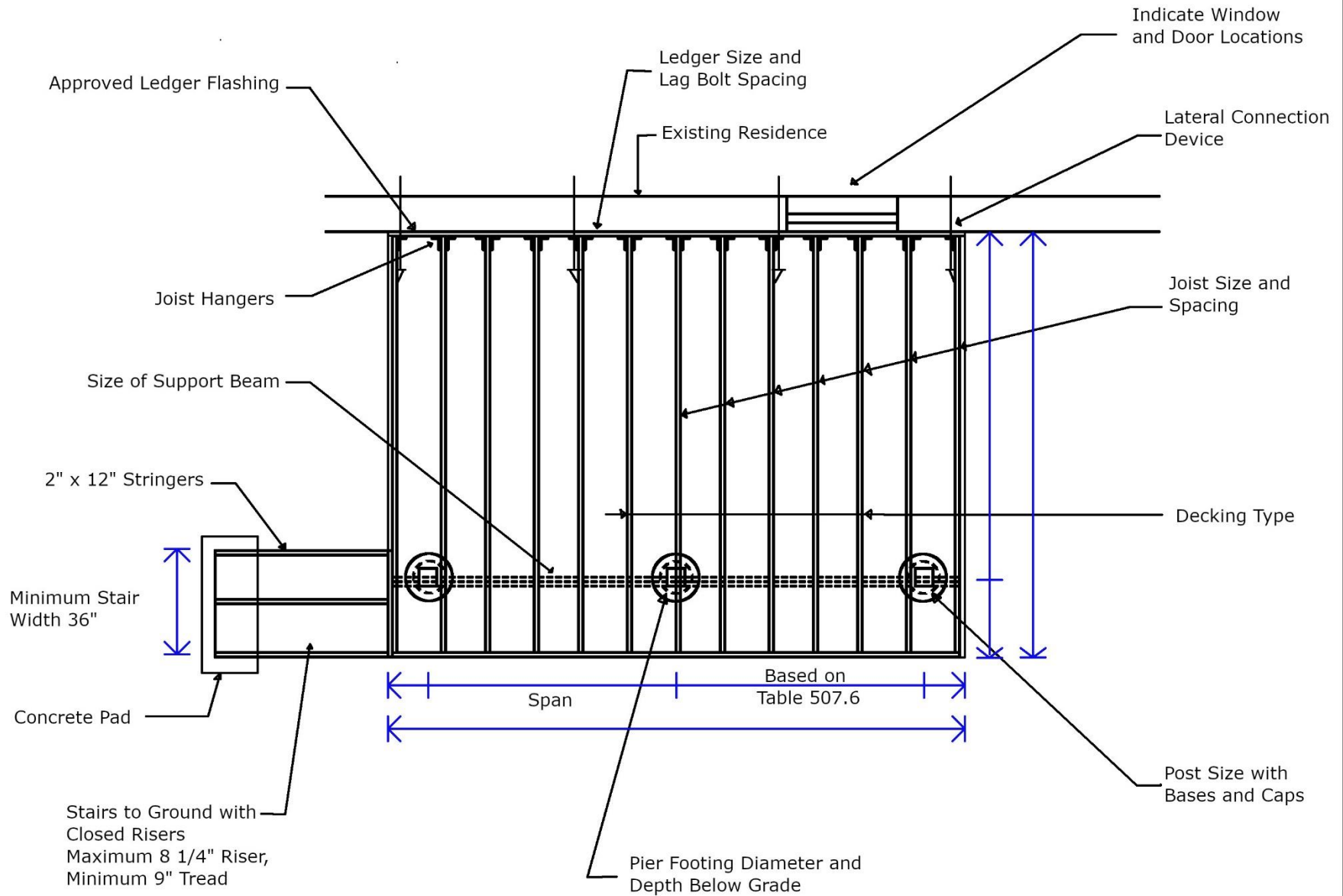

Standard Deck Details

Beam/Post Connection Options

Notched Post Option

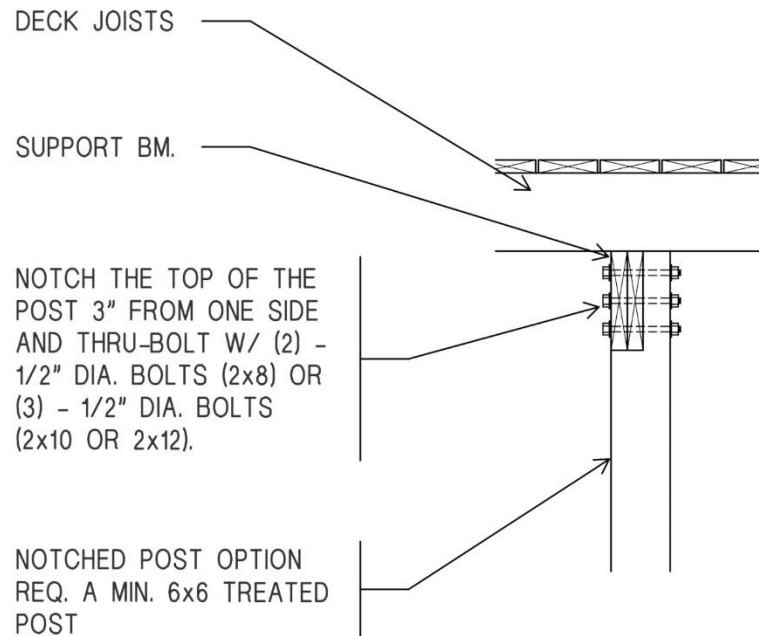

Post Cap Option

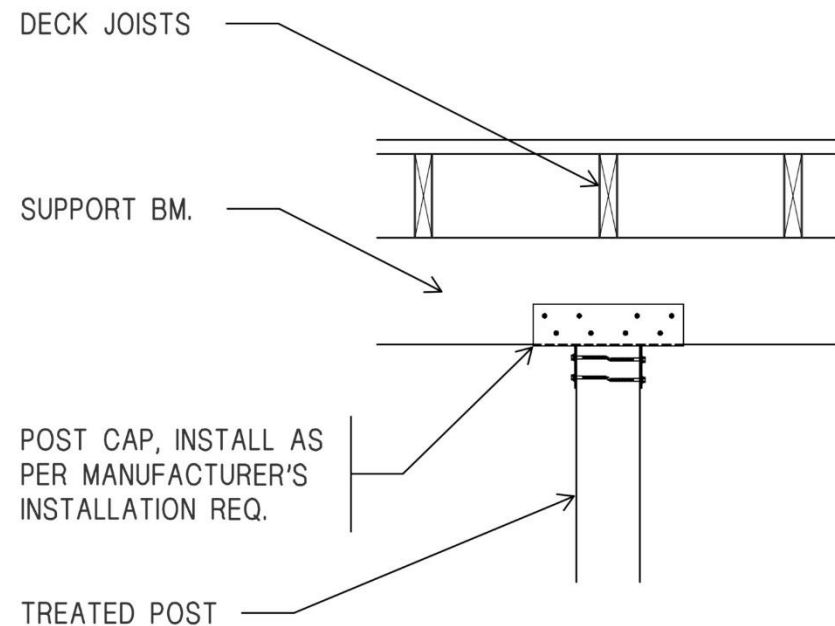

Standard Deck Details

Guard Post, Post/Pier Connection, Stair/Handrail Connection

